



# Keeping Industry Turning

W Series

Heavy Duty Cast Iron and Cast Aluminum

**BROOK  
CROMPTON**  
a **WOLONG** company

## W Series NEMA 143T-447T - TEFC Heavy Duty Cast Iron Construction



Heavy Duty Cast Iron Construction: Frame, End Brackets, & Conduit Box With Heavy Gauge Steel Fanguard and Non-sparking Fan, for Severe Duty Applications. Features Include:

- NEMA MG1-Part 31 inverter duty 15:1 constant torque, 20:1 variable torque
- 1.25 service factor at 60Hz, 1.0 service factor at 50Hz
- Class F insulation with class B temperature rise
- Removable/ repositionable feet for easy conversion to F1, F2, F3 (F0), or round body configuration
- IP55 degree of protection for washdown duty applications
- Full contact shaft seals inside both brackets for increased protection against contaminants
- Dual rated 60/50Hz at same HP
- Cast iron conduit box with drilled and tapped entry is rotatable in 90 degree increments
- CSA approved for Class I; Division 2; Groups A, B, C & D, Zone 2; Groups IIA & IIB T3 on sine wave power
- Internal tropicproof
- 3 year warranty

### Notes:

RF - Removable Feet

TM - Thermistors

RB - Roller Bearing On Drive End



## W Series NEMA 143T-447T - TEFC Foot Mounted - Heavy Duty Cast Iron

HP	RPM	Frame	Voltage	P/N	FL Eff.	C Dim. (IN)	S.F. 60 Hz	FL Amps	LBS	Notes
1	1800	143/5T	230/460 V	BC4N001-4	85.5	14.18	1.25	1.50	58	RF
	1800	143/5T	575 V	BC4N001-5	85.5	14.18	1.25	1.20	58	RF
	1200	145T	230/460 V	PC6N001-4	82.5	14.00	1.25	1.70	60	RF
	1200	145T	575 V	PC6N001-5	82.5	14.00	1.25	1.40	60	RF
1.5	3600	143/5T	230/460 V	BC2N1.5-4	84	14.18	1.25	1.90	58	RF
	3600	143/5T	575 V	BC2N1.5-5	84	14.18	1.25	1.50	58	RF
	1800	143/5T	230/460 V	BC4N1.5-4	86.5	14.18	1.25	2.10	60	RF
	1800	143/5T	575 V	BC4N1.5-5	86.5	14.18	1.25	1.60	60	RF
	1200	182T	230/460 V	PC6N1.5-4	87.5	15.50	1.25	2.20	124	RF
	1200	182T	575 V	PC6N1.5-5	87.5	15.50	1.25	1.80	124	RF
2	3600	143/5T	230/460 V	BC2N002-4	85.5	14.18	1.25	2.60	60	RF
	3600	143/5T	575 V	BC2N002-5	85.5	14.18	1.25	2.00	60	RF
	1800	143/5T	230/460 V	BC4N002-4	86.5	14.18	1.25	2.90	60	RF
	1800	143/5T	575 V	BC4N002-5	86.5	14.18	1.25	2.30	60	RF
	1200	184T	230/460 V	PC6N002-4	88.5	16.50	1.25	3.00	136	RF
	1200	184T	575 V	PC6N002-5	88.5	16.50	1.25	2.40	136	RF
3	3600	182/4T	230/460 V	BC2N003-4	86.5	15.43	1.25	3.50	124	RF
	3600	182/4T	575 V	BC2N003-5	86.5	15.43	1.25	2.80	124	RF
	1800	182/4T	230/460 V	BC4N003-4	89.5	15.43	1.25	3.90	124	RF
	1800	182/4T	575 V	BC4N003-5	89.5	15.43	1.25	3.10	124	RF
	1200	213T	230/460 V	PC6N003-4	89.5	19.30	1.25	4.20	204	RF
	1200	213T	575 V	PC6N003-5	89.5	19.30	1.25	3.40	204	RF
5	3600	182/4T	230/460 V	BC2N005-4	88.5	16.27	1.25	5.90	136	RF
	3600	182/4T	575 V	BC2N005-5	88.5	16.27	1.25	4.70	136	RF
	1800	182/4T	230/460 V	BC4N005-4	89.5	16.27	1.25	6.50	136	RF
	1800	182/4T	575 V	BC4N005-5	89.5	16.27	1.25	5.00	136	RF
	1200	215T	230/460 V	PC6N005-4	89.5	18.78	1.25	7.10	220	RF
	1200	215T	575 V	PC6N005-5	89.5	18.78	1.25	5.70	220	RF
7.5	3600	213/5T	230/460 V	BC2N7.5-4	89.5	19.30	1.25	8.40	204	RF
	3600	213/5T	575 V	BC2N7.5-5	89.5	19.30	1.25	6.70	204	RF
	1800	213/5T	230/460 V	BC4N7.5-4	91.7	19.30	1.25	9.80	204	RF
	1800	213/5T	575 V	BC4N7.5-5	91.7	19.30	1.25	7.80	204	RF
	1200	254/6T	230/460 V	BC6N7.5-4	91	20.28	1.25	10.90	320	RF, TM
	1200	254/6T	575 V	BC6N7.5-5	91	23.44	1.25	8.70	320	RF, TM
10	3600	213/5T	230/460 V	BC2N010-4	90.2	19.30	1.25	11.60	220	RF
	3600	213/5T	575 V	BC2N010-5	90.2	19.30	1.25	9.30	220	RF
	1800	213/5T	230/460 V	BC4N010-4	91.7	19.30	1.25	13.20	220	RF
	1800	213/5T	575 V	BC4N010-5	91.7	19.30	1.25	10.50	220	RF
	1200	254/6T	230/460 V	BC6N010-4	91	23.44	1.25	14.30	374	RF, TM
	1200	254/6T	575 V	BC6N010-5	91	23.44	1.25	11.40	374	RF, TM
15	3600	254/6T	230/460 V	BC2N015-4	91	23.44	1.25	17.00	320	RF, TM
	3600	254/6T	575 V	BC2N015-5	91	23.44	1.25	13.60	320	RF, TM
	1800	254/6T	230/460 V	BC4N015-4	92.4	23.44	1.25	17.80	320	RF, TM
	1800	254/6T	575 V	BC4N015-5	92.4	23.44	1.25	14.20	320	RF, TM
	1200	284/6T	230/460 V	BC6N015-4	91.7	26.34	1.25	21.30	478	RF, TM
	1200	284/6T	575 V	BC6N015-5	91.7	26.34	1.25	17.00	478	RF, TM
20	3600	254/6T	230/460 V	BC2N020-4	91	23.44	1.25	22.20	374	RF, TM
	3600	254/6T	575 V	BC2N020-5	91	23.44	1.25	17.80	374	RF, TM
	1800	254/6T	230/460 V	BC4N020-4	93	23.44	1.25	23.30	374	RF, TM
	1800	254/6T	575 V	BC4N020-5	93	23.44	1.25	18.60	374	RF, TM
	1200	284/6T	230/460 V	BC6N020-4	91.7	26.34	1.25	27.60	470	RF, TM
	1200	284/6T	575 V	BC6N020-5	91.7	26.34	1.25	22.10	470	RF, TM

Discount Category **55**



## W Series NEMA 143T-447T - TEFC Foot Mounted - Heavy Duty Cast Iron

HP	RPM	Frame	Voltage	P/N	FL Eff.	C Dim. (IN)	S.F. 60 Hz	FL Amps	LBS	Notes
25	3600	284/6TS	230/460 V	BC2N025-4	91.7	24.97	1.25	27.20	478	RF, TM
	3600	284/6TS	575 V	BC2N025-5	91.7	24.97	1.25	21.80	478	RF, TM
	1800	284/6T	230/460 V	BC4N025-4	93.6	26.34	1.25	27.90	478	RF, TM
	1800	284/6T	575 V	BC4N025-5	93.6	26.34	1.25	22.30	478	RF, TM
	1200	324T	230/460 V	BC6N025-4	93	32.75	1.25	32.30	650	RF, TM
	1200	324T	575 V	BC6N025-5	93	32.75	1.25	25.80	650	RF, TM
30	3600	284/6TS	230/460 V	BC2N030-4	91.7	24.97	1.25	32.40	470	RF, TM
	3600	284/6TS	575 V	BC2N030-5	91.7	24.97	1.25	25.90	470	RF, TM
	1800	284/6T	230/460 V	BC4N030-4	93.6	26.34	1.25	33.90	470	RF, TM
	1800	284/6T	575 V	BC4N030-5	93.6	26.34	1.25	27.10	470	RF, TM
	1200	326T	230/460 V	BC6N030-4	93	32.75	1.25	39.30	750	RF, TM
	1200	326T	575 V	BC6N030-5	93	32.75	1.25	31.40	750	RF, TM
40	3600	324TS	230/460 V	BC2N040-4	93	31.25	1.25	46.00	650	RF, TM
	3600	324TS	575 V	BC2N040-5	93	31.25	1.25	36.80	650	RF, TM
	1800	324T	230/460 V	BC4N040-4	94.1	32.75	1.25	45.00	650	RF, TM
	1800	324T	575 V	BC4N040-5	94.1	32.75	1.25	36.00	650	RF, TM
	1200	364T	230/460 V	BC6N040-4	94.1	32.75	1.25	50.40	914	RF, TM
	1200	364T	575 V	BC6N040-5	94.1	32.75	1.25	40.30	914	RF, TM
50	3600	326TS	230/460 V	BC2N050-4	93.6	32.75	1.25	57.00	750	RF, TM
	3600	326TS	575 V	BC2N050-5	93.6	32.75	1.25	45.60	750	RF, TM
	1800	326T	230/460 V	BC4N050-4	94.5	34.25	1.25	58.00	750	RF, TM
	1800	326T	575 V	BC4N050-5	94.5	34.25	1.25	46.40	750	RF, TM
	1200	365T	230/460 V	BC6N050-4	94.1	38.50	1.25	63.80	1050	RF, TM
	1200	365T	575 V	BC6N050-5	94.1	38.50	1.25	51.00	1050	RF, TM
60	3600	364TS	230/460 V	BC2N060-4	93.6	34.25	1.25	66.00	914	RF, TM
	3600	364TS	575 V	BC2N060-5	93.6	34.25	1.25	52.80	914	RF, TM
	1800	364T	230/460 V	BC4N060-4	95	36.38	1.25	68.00	914	RF, TM
	1800	364T	575 V	BC4N060-5	95	36.38	1.25	54.40	914	RF, TM
	1200	404T	230/460 V	BC6N060-4	94.5	42.25	1.25	74.30	1384	RF, TM
	1200	404T	575 V	BC6N060-5	94.5	42.25	1.25	59.40	1384	RF, TM
75	3600	365TS	230/460 V	BC2N075-4	93.6	34.25	1.25	79.30	1050	RF, TM
	3600	365TS	575 V	BC2N075-5	93.6	34.25	1.25	63.40	1050	RF, TM
	1800	365T	230/460 V	BC4N075-4	95.4	38.50	1.25	81.30	1050	RF, TM
	1800	365T	575 V	BC4N075-5	95.4	38.50	1.25	65.00	1050	RF, TM
	1200	405T	230/460 V	BC6N075-4	94.5	42	1.25	90.60	1384	RF, TM
	1200	405T	575 V	BC6N075-5	94.5	42	1.25	72.50	1384	RF, TM
100	3600	405TS	230/460 V	BC2N100-4	94.1	41	1.25	110.00	1384	RF, TM
	3600	405TS	575 V	BC2N100-5	94.1	41	1.25	88.00	1384	RF, TM
	1800	405T	230/460 V	BC4N100-4	95.4	42	1.25	116.00	1384	RF, TM
	1800	405T	230/460 V	BC4N100-4-55	95.4	42	1.25	116.00	1384	RF, TM, RB
	1800	405T	575 V	BC4N100-5	95.4	42	1.25	92.80	1384	RF, TM
	1800	405T	575 V	BC4N100-5-55	95.4	42	1.25	92.80	1384	RF, TM, RB
	1200	444T	230/460 V	BC6N100-4	95	47	1.25	117.30	1512	RF, TM
	1200	444T	230/460 V	BC6N100-4-55	95	47	1.25	117.30	1512	RF, TM, RB
	1200	444T	575 V	BC6N100-5	95	47	1.25	93.80	1512	RF, TM
	1200	444T	575 V	BC6N100-5-55	95	47	1.25	93.80	1512	RF, TM, RB
125	3600	444TS	460 V	BC2N125-9	95	43.25	1.25	137.00	1512	RF, TM
	3600	444TS	575 V	BC2N125-5	95	43.25	1.25	109.60	1512	RF, TM
	1800	444T	460 V	BC4N125-9	95.4	47	1.25	144.00	1512	RF, TM
	1800	444T	460 V	BC4N125-9-55	95.4	47	1.25	144.00	1512	RF, TM, RB
	1800	444T	575 V	BC4N125-5	95.4	47	1.25	115.20	1512	RF, TM
	1800	444T	575 V	BC4N125-5-55	95.4	47	1.25	115.20	1512	RF, TM, RB

Discount Category **55**



## W Series NEMA 143T-447T - TEFC Foot Mounted - Heavy Duty Cast Iron

HP	RPM	Frame	Voltage	P/N	FL Eff.	C Dim. (IN)	S.F. 60 Hz	FL Amps	LBS	Notes
125	1200	445T	460 V	BC6N125-9	95	49.63	1.25	148.40	1896	RF, TM
	1200	445T	460 V	BC6N125-9-55	95	49.63	1.25	148.40	1896	RF, TM, RB
	1200	445T	575 V	BC6N125-5	95	49.63	1.25	118.70	1896	RF, TM
	1200	445T	575 V	BC6N125-5-55	95	49.63	1.25	118.70	1896	RF, TM, RB
150	3600	445TS	460 V	BC2N150-9	95	45.88	1.25	161.00	1896	RF, TM
	3600	445TS	575 V	BC2N150-5	95	45.88	1.25	128.80	1896	RF, TM
	1800	445T	460 V	BC4N150-9	95.8	49.63	1.25	170.00	1896	RF, TM
	1800	445T	460 V	BC4N150-9-55	95.8	49.63	1.25	170.00	1896	RF, TM, RB
	1800	445T	575 V	BC4N150-5	95.8	49.63	1.25	136.00	1896	RF, TM
	1800	445T	575 V	BC4N150-5-55	95.8	49.63	1.25	136.00	1896	RF, TM, RB
	1200	447T	460 V	BC6N150-9	95.8	49.63	1.25	174.50	2300	RF, TM
	1200	447T	460 V	BC6N150-9-55	95.8	49.63	1.25	174.50	2300	RF, TM, RB
	1200	447T	575 V	BC6N150-5	95.8	49.63	1.25	139.60	2300	RF, TM
	1200	447T	575 V	BC6N150-5-55	95.8	49.63	1.25	139.60	2300	RF, TM, RB
200	3600	447TS	460 V	BC2N200-9	95.4	45.88	1.25	215.00	2300	RF, TM
	3600	447TS	575 V	BC2N200-5	95.4	45.88	1.25	172.00	2300	RF, TM
	1800	447T	460 V	BC4N200-9	96.2	49.63	1.25	221.00	2300	RF, TM
	1800	447T	460 V	BC4N200-9-55	96.2	49.63	1.25	221.00	2300	RF, TM, RB
	1800	447T	575 V	BC4N200-5	96.2	49.63	1.25	176.80	2300	RF, TM
	1800	447T	575 V	BC4N200-5-55	96.2	49.63	1.25	176.80	2300	RF, TM, RB

Discount Category **55**

Larger Ratings Available By Special Order in Both Low and Medium Voltage Designs.  
Please Contact Brook Crompton For Pricing.

# W Series NEMA 143TC-447TC - TEFC

## C-Face With Removable Feet - Heavy Duty Cast Iron

HP	RPM	Frame	Voltage	P/N	FL Eff.	C Dim. (IN)	S.F. 60 Hz	FL Amps	LBS	Notes
1	1800	143/5TC	230/460 V	BC4N001-4C	85.5	14.18	1.25	1.50	68	RF
	1800	143/5TC	575 V	BC4N001-5C	85.5	14.18	1.25	1.20	68	RF
	1200	145TC	230/460 V	PC6N001-4C	82.5	14.00	1.25	1.70	70	RF
	1200	145TC	575 V	PC6N001-5C	82.5	14.00	1.25	1.40	70	RF
1.5	3600	143/5TC	230/460 V	BC2N1.5-4C	84	14.18	1.25	1.90	68	RF
	3600	143/5TC	575 V	BC2N1.5-5C	84	14.18	1.25	1.50	68	RF
	1800	143/5TC	230/460 V	BC4N1.5-4C	86.5	14.18	1.25	2.10	70	RF
	1800	143/5TC	575 V	BC4N1.5-5C	86.5	14.18	1.25	1.60	70	RF
	1200	182TC	230/460 V	PC6N1.5-4C	87.5	15.50	1.25	2.20	134	RF
	1200	182TC	575 V	PC6N1.5-5C	87.5	15.50	1.25	1.80	134	RF
2	3600	143/5TC	230/460 V	BC2N002-4C	85.5	14.18	1.25	2.60	70	RF
	3600	143/5TC	575 V	BC2N002-5C	85.5	14.18	1.25	2.00	70	RF
	1800	143/5TC	230/460 V	BC4N002-4C	86.5	14.18	1.25	2.90	70	RF
	1800	143/5TC	575 V	BC4N002-5C	86.5	14.18	1.25	2.30	70	RF
	1200	184TC	230/460 V	PC6N002-4C	88.5	16.50	1.25	3.00	146	RF
	1200	184TC	575 V	PC6N002-5C	88.5	16.50	1.25	2.40	146	RF
3	3600	182/4TC	230/460 V	BC2N003-4C	86.5	15.43	1.25	3.50	134	RF
	3600	182/4TC	575 V	BC2N003-5C	86.5	15.43	1.25	2.80	134	RF
	1800	182/4TC	230/460 V	BC4N003-4C	89.5	15.43	1.25	3.90	134	RF
	1800	182/4TC	575 V	BC4N003-5C	89.5	15.43	1.25	3.10	134	RF
	1200	213TC	230/460 V	PC6N003-4C	89.5	19.30	1.25	4.20	206	RF
	1200	213TC	575 V	PC6N003-5C	89.5	19.30	1.25	3.40	206	RF
5	3600	182/4TC	230/460 V	BC2N005-4C	88.5	16.27	1.25	5.90	146	RF
	3600	182/4TC	575 V	BC2N005-5C	88.5	16.27	1.25	4.70	146	RF
	1800	182/4TC	230/460 V	BC4N005-4C	89.5	16.27	1.25	6.50	146	RF
	1800	182/4TC	575 V	BC4N005-5C	89.5	16.27	1.25	5.00	146	RF
	1200	215TC	230/460 V	PC6N005-4C	89.5	18.78	1.25	7.10	232	RF
	1200	215TC	575 V	PC6N005-5C	89.5	18.78	1.25	5.70	232	RF
7.5	3600	213/5TC	230/460 V	BC2N7.5-4C	89.5	19.30	1.25	8.40	216	RF
	3600	213/5TC	575 V	BC2N7.5-5C	89.5	19.30	1.25	6.70	216	RF
	1800	213/5TC	230/460 V	BC4N7.5-4C	91.7	19.30	1.25	9.80	216	RF
	1800	213/5TC	575 V	BC4N7.5-5C	91.7	19.30	1.25	7.80	216	RF
	1200	254/6TC	230/460 V	BC6N7.5-4C	91	20.28	1.25	10.90	334	RF, TM
	1200	254/6TC	575 V	BC6N7.5-5C	91	23.44	1.25	8.70	334	RF, TM
10	3600	213/5TC	230/460 V	BC2N010-4C	90.2	19.30	1.25	11.60	232	RF
	3600	213/5TC	575 V	BC2N010-5C	90.2	19.30	1.25	9.30	232	RF
	1800	213/5TC	230/460 V	BC4N010-4C	91.7	19.30	1.25	13.20	232	RF
	1800	213/5TC	575 V	BC4N010-5C	91.7	19.30	1.25	10.50	232	RF
	1200	254/6TC	230/460 V	BC6N010-4C	91	23.44	1.25	14.30	386	RF, TM
	1200	254/6TC	575 V	BC6N010-5C	91	23.44	1.25	11.40	386	RF, TM
15	3600	254/6TC	230/460 V	BC2N015-4C	91	23.44	1.25	17.00	334	RF, TM
	3600	254/6TC	575 V	BC2N015-5C	91	23.44	1.25	13.60	334	RF, TM
	1800	254/6TC	230/460 V	BC4N015-4C	92.4	23.44	1.25	17.80	334	RF, TM
	1800	254/6TC	575 V	BC4N015-5C	92.4	23.44	1.25	14.20	334	RF, TM
	1200	284/6TC	230/460 V	BC6N015-4C	91.7	26.34	1.25	21.30	492	RF, TM
	1200	284/6TC	575 V	BC6N015-5C	91.7	26.34	1.25	17.00	492	RF, TM
20	3600	254/6TC	230/460 V	BC2N020-4C	91	23.44	1.25	22.20	388	RF, TM
	3600	254/6TC	575 V	BC2N020-5C	91	23.44	1.25	17.80	388	RF, TM
	1800	254/6TC	230/460 V	BC4N020-4C	93	23.44	1.25	23.30	388	RF, TM
	1800	254/6TC	575 V	BC4N020-5C	93	23.44	1.25	18.60	388	RF, TM
	1200	284/6TC	230/460 V	BC6N020-4C	91.7	26.34	1.25	27.60	484	RF, TM
	1200	284/6TC	575 V	BC6N020-5C	91.7	26.34	1.25	22.10	484	RF, TM

Discount Category **55**



## W Series NEMA 143TC-447TC - TEFC C-Face With Removable Feet - Heavy Duty Cast Iron

HP	RPM	Frame	Voltage	P/N	FL Eff.	C Dim. (IN)	S.F. 60 Hz	FL Amps	LBS	Notes
25	3600	284/6TSC	230/460 V	BC2N025-4C	91.7	24.97	1.25	27.20	492	RF, TM
	3600	284/6TSC	575 V	BC2N025-5C	91.7	24.97	1.25	21.80	492	RF, TM
	1800	284/6TC	230/460 V	BC4N025-4C	93.6	26.34	1.25	27.90	492	RF, TM
	1800	284/6TC	575 V	BC4N025-5C	93.6	26.34	1.25	22.30	492	RF, TM
	1200	324TC	230/460 V	BC6N025-4C	93	32.75	1.25	32.30	675	RF, TM
	1200	324TC	575 V	BC6N025-5C	93	32.75	1.25	25.80	675	RF, TM
30	3600	284/6TSC	230/460 V	BC2N030-4C	91.7	24.97	1.25	32.40	484	RF, TM
	3600	284/6TSC	575 V	BC2N030-5C	91.7	24.97	1.25	25.90	484	RF, TM
	1800	284/6TC	230/460 V	BC4N030-4C	93.6	26.34	1.25	33.90	484	RF, TM
	1800	284/6TC	575 V	BC4N030-5C	93.6	26.34	1.25	27.10	484	RF, TM
	1200	326TC	230/460 V	BC6N030-4C	93	32.75	1.25	39.30	775	RF, TM
	1200	326TC	575 V	BC6N030-5C	93	32.75	1.25	31.40	775	RF, TM
40	3600	324TSC	230/460 V	BC2N040-4C	93	31.25	1.25	46.00	675	RF, TM
	3600	324TSC	575 V	BC2N040-5C	93	31.25	1.25	36.80	675	RF, TM
	1800	324TC	230/460 V	BC4N040-4C	94.1	32.75	1.25	45.00	675	RF, TM
	1800	324TC	575 V	BC4N040-5C	94.1	32.75	1.25	36.00	675	RF, TM
	1200	364TC	230/460 V	BC6N040-4C	94.1	32.75	1.25	50.40	939	RF, TM
	1200	364TC	575 V	BC6N040-5C	94.1	32.75	1.25	40.30	939	RF, TM
50	3600	326TSC	230/460 V	BC2N050-4C	93.6	32.75	1.25	57.00	775	RF, TM
	3600	326TSC	575 V	BC2N050-5C	93.6	32.75	1.25	45.60	775	RF, TM
	1800	326TC	230/460 V	BC4N050-4C	94.5	34.25	1.25	58.00	775	RF, TM
	1800	326TC	575 V	BC4N050-5C	94.5	34.25	1.25	46.40	775	RF, TM
	1200	365TC	230/460 V	BC6N050-4C	94.1	38.50	1.25	63.80	1075	RF, TM
	1200	365TC	575 V	BC6N050-5C	94.1	38.50	1.25	51.00	1075	RF, TM
60	3600	364TSC	230/460 V	BC2N060-4C	93.6	34.25	1.25	66.00	939	RF, TM
	3600	364TSC	575 V	BC2N060-5C	93.6	34.25	1.25	52.80	939	RF, TM
	1800	364TC	230/460 V	BC4N060-4C	95	36.38	1.25	68.00	939	RF, TM
	1800	364TC	575 V	BC4N060-5C	95	36.38	1.25	54.40	939	RF, TM
	1200	404TC	230/460 V	BC6N060-4C	94.5	42.25	1.25	74.30	1439	RF, TM
	1200	404TC	575 V	BC6N060-5C	94.5	42.25	1.25	59.40	1439	RF, TM
75	3600	365TSC	230/460 V	BC2N075-4C	93.6	34.25	1.25	79.30	1075	RF, TM
	3600	365TSC	575 V	BC2N075-5C	93.6	34.25	1.25	63.40	1075	RF, TM
	1800	365TC	230/460 V	BC4N075-4C	95.4	38.50	1.25	81.30	1075	RF, TM
	1800	365TC	575 V	BC4N075-5C	95.4	38.50	1.25	65.00	1075	RF, TM
	1200	405TC	230/460 V	BC6N075-4C	94.5	42	1.25	90.60	1439	RF, TM
	1200	405TC	575 V	BC6N075-5C	94.5	42	1.25	72.50	1439	RF, TM
100	3600	405TSC	230/460 V	BC2N100-4C	94.1	41	1.25	110.00	1439	RF, TM
	3600	405TSC	575 V	BC2N100-5C	94.1	41	1.25	88.00	1439	RF, TM
	1800	405TC	230/460 V	BC4N100-4C	95.4	42	1.25	116.00	1439	RF, TM
	1800	405TC	575 V	BC4N100-5C	95.4	42	1.25	92.80	1439	RF, TM
	1200	444TC	230/460 V	BC6N100-4C	95	47	1.25	117.30	1567	RF, TM
	1200	444TC	575 V	BC6N100-5C	95	47	1.25	93.80	1567	RF, TM
125	3600	444TSC	460 V	BC2N125-9C	95	43.25	1.25	137.00	1567	RF, TM
	3600	444TSC	575 V	BC2N125-5C	95	43.25	1.25	109.60	1567	RF, TM
	1800	444TC	460 V	BC4N125-9C	95.4	47	1.25	144.00	1567	RF, TM
	1800	444TC	575 V	BC4N125-5C	95.4	47	1.25	115.20	1567	RF, TM
	1200	445TC	460 V	BC6N125-9C	95	49.63	1.25	148.40	1951	RF, TM
	1200	445TC	575 V	BC6N125-5C	95	49.63	1.25	118.70	1951	RF, TM

Discount Category **55**

**W Series NEMA 143TC-447TC - TEFC  
C-Face With Removable Feet - Heavy Duty Cast Iron**

HP	RPM	Frame	Voltage	P/N	FL Eff.	C Dim. (IN)	S.F. 60 Hz	FL Amps	LBS	Notes
150	3600	445TSC	460 V	BC2N150-9C	95	45.88	1.25	161.00	1951	RF, TM
	3600	445TSC	575 V	BC2N150-5C	95	45.88	1.25	128.80	1951	RF, TM
	1800	445TC	460 V	BC4N150-9C	95.8	49.63	1.25	170.00	1951	RF, TM
	1800	445TC	575 V	BC4N150-5C	95.8	49.63	1.25	136.00	1951	RF, TM
	1200	447TC	460 V	BC6N150-9C	95.8	49.63	1.25	174.50	2355	RF, TM
	1200	447TC	575 V	BC6N150-5C	95.8	49.63	1.25	139.60	2355	RF, TM
200	3600	447TSC	460 V	BC2N200-9C	95.4	45.88	1.25	215.00	2355	RF, TM
	3600	447TSC	575 V	BC2N200-5C	95.4	45.88	1.25	172.00	2355	RF, TM
	1800	447TC	460 V	BC4N200-9C	96.2	49.63	1.25	221.00	2355	RF, TM
	1800	447TC	575 V	BC4N200-5C	96.2	49.63	1.25	176.80	2355	RF, TM

Discount Category **55**

Larger Ratings Available By Special Order in Both Low and Medium Voltage Designs.  
Please Contact Brook Crompton For Pricing.



## W Series NEMA 143TD-447TD - TEFC D-Flange With Removable Feet - Heavy Duty Cast Iron

HP	RPM	Frame	Voltage	P/N	FL Eff.	C Dim. (IN)	S.F. 60 Hz	FL Amps	LBS	Notes
1	1800	143/5TD	230/460 V	BC4N001-4D	85.5	14.18	1.25	1.50	68	RF
	1800	143/5TD	575 V	BC4N001-5D	85.5	14.18	1.25	1.20	68	RF
	1200	145TD	230/460 V	PC6N001-4D	82.5	14.00	1.25	1.70	70	RF
	1200	145TD	575 V	PC6N001-5D	82.5	14.00	1.25	1.40	70	RF
1.5	3600	143/5TD	230/460 V	BC2N1.5-4D	84	14.18	1.25	1.90	68	RF
	3600	143/5TD	575 V	BC2N1.5-5D	84	14.18	1.25	1.50	68	RF
	1800	143/5TD	230/460 V	BC4N1.5-4D	86.5	14.18	1.25	2.10	70	RF
	1800	143/5TD	575 V	BC4N1.5-5D	86.5	14.18	1.25	1.60	70	RF
	1200	182TD	230/460 V	PC6N1.5-4D	87.5	15.50	1.25	2.20	134	RF
	1200	182TD	575 V	PC6N1.5-5D	87.5	15.50	1.25	1.80	134	RF
2	3600	143/5TD	230/460 V	BC2N002-4D	85.5	14.18	1.25	2.60	70	RF
	3600	143/5TD	575 V	BC2N002-5D	85.5	14.18	1.25	2.00	70	RF
	1800	143/5TD	230/460 V	BC4N002-4D	86.5	14.18	1.25	2.90	70	RF
	1800	143/5TD	575 V	BC4N002-5D	86.5	14.18	1.25	2.30	70	RF
	1200	184TD	230/460 V	PC6N002-4D	88.5	16.50	1.25	3.00	146	RF
	1200	184TD	575 V	PC6N002-5D	88.5	16.50	1.25	2.40	146	RF
3	3600	182/4TD	230/460 V	BC2N003-4D	86.5	15.43	1.25	3.50	134	RF
	3600	182/4TD	575 V	BC2N003-5D	86.5	15.43	1.25	2.80	134	RF
	1800	182/4TD	230/460 V	BC4N003-4D	89.5	15.43	1.25	3.90	134	RF
	1800	182/4TD	575 V	BC4N003-5D	89.5	15.43	1.25	3.10	134	RF
	1200	213TD	230/460 V	PC6N003-4D	89.5	19.30	1.25	4.20	206	RF
	1200	213TD	575 V	PC6N003-5D	89.5	19.30	1.25	3.40	206	RF
5	3600	182/4TD	230/460 V	BC2N005-4D	88.5	16.27	1.25	5.90	146	RF
	3600	182/4TD	575 V	BC2N005-5D	88.5	16.27	1.25	4.70	146	RF
	1800	182/4TD	230/460 V	BC4N005-4D	89.5	16.27	1.25	6.50	146	RF
	1800	182/4TD	575 V	BC4N005-5D	89.5	16.27	1.25	5.00	146	RF
	1200	215TD	230/460 V	PC6N005-4D	89.5	18.78	1.25	7.10	232	RF
	1200	215TD	575 V	PC6N005-5D	89.5	18.78	1.25	5.70	232	RF
7.5	3600	213/5TD	230/460 V	BC2N7.5-4D	89.5	19.30	1.25	8.40	216	RF
	3600	213/5TD	575 V	BC2N7.5-5D	89.5	19.30	1.25	6.70	216	RF
	1800	213/5TD	230/460 V	BC4N7.5-4D	91.7	19.30	1.25	9.80	216	RF
	1800	213/5TD	575 V	BC4N7.5-5D	91.7	19.30	1.25	7.80	216	RF
	1200	254/6TD	230/460 V	BC6N7.5-4D	91	20.28	1.25	10.90	334	RF, TM
	1200	254/6TD	575 V	BC6N7.5-5D	91	23.44	1.25	8.70	334	RF, TM
10	3600	213/5TD	230/460 V	BC2N010-4D	90.2	19.30	1.25	11.60	232	RF
	3600	213/5TD	575 V	BC2N010-5D	90.2	19.30	1.25	9.30	232	RF
	1800	213/5TD	230/460 V	BC4N010-4D	91.7	19.30	1.25	13.20	232	RF
	1800	213/5TD	575 V	BC4N010-5D	91.7	19.30	1.25	10.50	232	RF
	1200	254/6TD	230/460 V	BC6N010-4D	91	23.44	1.25	14.30	386	RF, TM
	1200	254/6TD	575 V	BC6N010-5D	91	23.44	1.25	11.40	386	RF, TM
15	3600	254/6TD	230/460 V	BC2N015-4D	91	23.44	1.25	17.00	334	RF, TM
	3600	254/6TD	575 V	BC2N015-5D	91	23.44	1.25	13.60	334	RF, TM
	1800	254/6TD	230/460 V	BC4N015-4D	92.4	23.44	1.25	17.80	334	RF, TM
	1800	254/6TD	575 V	BC4N015-5D	92.4	23.44	1.25	14.20	334	RF, TM
	1200	284/6TD	230/460 V	BC6N015-4D	91.7	26.34	1.25	21.30	492	RF, TM
	1200	284/6TD	575 V	BC6N015-5D	91.7	26.34	1.25	17.00	492	RF, TM
20	3600	254/6TD	230/460 V	BC2N020-4D	91	23.44	1.25	22.20	388	RF, TM
	3600	254/6TD	575 V	BC2N020-5D	91	23.44	1.25	17.80	388	RF, TM
	1800	254/6TD	230/460 V	BC4N020-4D	93	23.44	1.25	23.30	388	RF, TM
	1800	254/6TD	575 V	BC4N020-5D	93	23.44	1.25	18.60	388	RF, TM
	1200	284/6TD	230/460 V	BC6N020-4D	91.7	26.34	1.25	27.60	484	RF, TM
	1200	284/6TD	575 V	BC6N020-5D	91.7	26.34	1.25	22.10	484	RF, TM

Discount Category **55**



## W Series NEMA 143TD-447TD - TEFC D-Flange With Removable Feet - Heavy Duty Cast Iron

HP	RPM	Frame	Voltage	P/N	FL Eff.	C Dim. (IN)	S.F. 60 Hz	FL Amps	LBS	Notes
25	3600	284/6TSD	230/460 V	BC2N025-4D	91.7	24.97	1.25	27.20	492	RF, TM
	3600	284/6TSD	575 V	BC2N025-5D	91.7	24.97	1.25	21.80	492	RF, TM
	1800	284/6TD	230/460 V	BC4N025-4D	93.6	26.34	1.25	27.90	492	RF, TM
	1800	284/6TD	575 V	BC4N025-5D	93.6	26.34	1.25	22.30	492	RF, TM
	1200	324TD	230/460 V	BC6N025-4D	93	32.75	1.25	32.30	675	RF, TM
	1200	324TD	575 V	BC6N025-5D	93	32.75	1.25	25.80	675	RF, TM
30	3600	284/6TSD	230/460 V	BC2N030-4D	91.7	24.97	1.25	32.40	484	RF, TM
	3600	284/6TSD	575 V	BC2N030-5D	91.7	24.97	1.25	25.90	484	RF, TM
	1800	284/6TD	230/460 V	BC4N030-4D	93.6	26.34	1.25	33.90	484	RF, TM
	1800	284/6TD	575 V	BC4N030-5D	93.6	26.34	1.25	27.10	484	RF, TM
	1200	326TD	230/460 V	BC6N030-4D	93	32.75	1.25	39.30	775	RF, TM
	1200	326TD	575 V	BC6N030-5D	93	32.75	1.25	31.40	775	RF, TM
40	3600	324TSD	230/460 V	BC2N040-4D	93	31.25	1.25	46.00	675	RF, TM
	3600	324TSD	575 V	BC2N040-5D	93	31.25	1.25	36.80	675	RF, TM
	1800	324TD	230/460 V	BC4N040-4D	94.1	32.75	1.25	45.00	675	RF, TM
	1800	324TD	575 V	BC4N040-5D	94.1	32.75	1.25	36.00	675	RF, TM
	1200	364TD	230/460 V	BC6N040-4D	94.1	32.75	1.25	50.40	939	RF, TM
	1200	364TD	575 V	BC6N040-5D	94.1	32.75	1.25	40.30	939	RF, TM
50	3600	326TSD	230/460 V	BC2N050-4D	93.6	32.75	1.25	57.00	775	RF, TM
	3600	326TSD	575 V	BC2N050-5D	93.6	32.75	1.25	45.60	775	RF, TM
	1800	326TD	230/460 V	BC4N050-4D	94.5	34.25	1.25	58.00	775	RF, TM
	1800	326TD	575 V	BC4N050-5D	94.5	34.25	1.25	46.40	775	RF, TM
	1200	365TD	230/460 V	BC6N050-4D	94.1	38.50	1.25	63.80	1075	RF, TM
	1200	365TD	575 V	BC6N050-5D	94.1	38.50	1.25	51.00	1075	RF, TM
60	3600	364TSD	230/460 V	BC2N060-4D	93.6	34.25	1.25	66.00	939	RF, TM
	3600	364TSD	575 V	BC2N060-5D	93.6	34.25	1.25	52.80	939	RF, TM
	1800	364TD	230/460 V	BC4N060-4D	95	36.38	1.25	68.00	939	RF, TM
	1800	364TD	575 V	BC4N060-5D	95	36.38	1.25	54.40	939	RF, TM
	1200	404TD	230/460 V	BC6N060-4D	94.5	42.25	1.25	74.30	1439	RF, TM
	1200	404TD	575 V	BC6N060-5D	94.5	42.25	1.25	59.40	1439	RF, TM
75	3600	365TSD	230/460 V	BC2N075-4D	93.6	34.25	1.25	79.30	1075	RF, TM
	3600	365TSD	575 V	BC2N075-5D	93.6	34.25	1.25	63.40	1075	RF, TM
	1800	365TD	230/460 V	BC4N075-4D	95.4	38.50	1.25	81.30	1075	RF, TM
	1800	365TD	575 V	BC4N075-5D	95.4	38.50	1.25	65.00	1075	RF, TM
	1200	405TD	230/460 V	BC6N075-4D	94.5	42	1.25	90.60	1439	RF, TM
	1200	405TD	575 V	BC6N075-5D	94.5	42	1.25	72.50	1439	RF, TM
100	3600	405TSD	230/460 V	BC2N100-4D	94.1	41	1.25	110.00	1439	RF, TM
	3600	405TSD	575 V	BC2N100-5D	94.1	41	1.25	88.00	1439	RF, TM
	1800	405TD	230/460 V	BC4N100-4D	95.4	42	1.25	116.00	1439	RF, TM
	1800	405TD	575 V	BC4N100-5D	95.4	42	1.25	92.80	1439	RF, TM
	1200	444TD	230/460 V	BC6N100-4D	95	47	1.25	117.30	1567	RF, TM
	1200	444TD	575 V	BC6N100-5D	95	47	1.25	93.80	1567	RF, TM
125	3600	444TSD	460 V	BC2N125-9D	95	43.25	1.25	137.00	1567	RF, TM
	3600	444TSD	575 V	BC2N125-5D	95	43.25	1.25	109.60	1567	RF, TM
	1800	444TD	460 V	BC4N125-9D	95.4	47	1.25	144.00	1567	RF, TM
	1800	444TD	575 V	BC4N125-5D	95.4	47	1.25	115.20	1567	RF, TM
	1200	445TD	460 V	BC6N125-9D	95	49.63	1.25	148.40	1951	RF, TM
	1200	445TD	575 V	BC6N125-5D	95	49.63	1.25	118.70	1951	RF, TM

Discount Category **55**



## W Series NEMA 143TD-447TD - TEFC D-Flange With Removable Feet - Heavy Duty Cast Iron

HP	RPM	Frame	Voltage	P/N	FL Eff.	C Dim. (IN)	S.F. 60 Hz	FL Amps	LBS	Notes
150	3600	445TSD	460 V	BC2N150-9D	95	45.88	1.25	161.00	1951	RF, TM
	3600	445TSD	575 V	BC2N150-5D	95	45.88	1.25	128.80	1951	RF, TM
	1800	445TD	460 V	BC4N150-9D	95.8	49.63	1.25	170.00	1951	RF, TM
	1800	445TD	575 V	BC4N150-5D	95.8	49.63	1.25	136.00	1951	RF, TM
	1200	447TD	460 V	BC6N150-9D	95.8	49.63	1.25	174.50	2355	RF, TM
	1200	447TD	575 V	BC6N150-5D	95.8	49.63	1.25	139.60	2355	RF, TM
200	3600	447TSD	460 V	BC2N200-9D	95.4	45.88	1.25	215.00	2355	RF, TM
	3600	447TSD	575 V	BC2N200-5D	95.4	45.88	1.25	172.00	2355	RF, TM
	1800	447TD	460 V	BC4N200-9D	96.2	49.63	1.25	221.00	2355	RF, TM
	1800	447TD	575 V	BC4N200-5D	96.2	49.63	1.25	176.80	2355	RF, TM

Discount Category **55**

Larger Ratings Available By Special Order in Both Low and Medium Voltage Designs.  
Please Contact Brook Crompton For Pricing.

## W Series IEC 80-315L - TEFC Heavy Duty Cast Iron Construction



Heavy Duty Cast Iron Construction: Frame, End Brackets, & Conduit Box With Heavy Gauge Steel Fanguard and Non-sparking Fan, for Severe Duty Applications. Features Include:

- NEMA MG1-Part 31 inverter duty 15:1 constant torque, 20:1 variable torque
- 1.25 service factor at 60Hz, 1.0 service factor at 50Hz
- Class F insulation with class B temperature rise
- IP55 degree of protection for washdown duty enclosure
- Full contact shaft seals inside both brackets for increased protection against contaminants
- Removable/ repositionable feet for easy conversion to terminal box on top, left, right, or round body configuration
- IEC style terminal blocks included inside junction box
- Meets IEC 60034 electrical performance and IEC 60072 dimensional standards
- Dual rated 60/50Hz at same HP
- Cast iron conduit box with drilled and tapped entry is rotatable in 90 degree increments
- CSA approved for Class I; Division 2; Groups A, B, C & D, Zone 2; Groups IIA & IIB T3 on sine wave power
- Internal tropicproof
- Thermistors included in motors 160M and above. 1 per phase
- 3 year warranty

**Notes:**

**RF** - Removable Feet  
**TM** - Thermistors  
**EU** - Euronorm Dimensions  
**BS** - British Standard Dimensions



## W Series IEC 80-315L - TEFC B3 (Foot Mount) - Cast Iron

HP	Kw	RPM	Frame	Voltage	P/N	FL Eff.	L Dim. (mm)	S.F. 60 Hz	FL Amps	LBS	Notes
1	0.75	3600	80	230/460 V	BC2M001-4	77	278	1.25	1.40	42	RF, EU
		3600	80	575 V	BC2M001-5	77	278	1.25	1.12	42	RF, EU
		1800	80	230/460 V	BC4M001-4	85.5	278	1.25	1.50	42	RF, EU
		1800	80	575 V	BC4M001-5	85.5	278	1.25	1.20	42	RF, EU
		1200	90S	230/460 V	PC6M001-4	82.5	320	1.25	1.70	58	RF, EU
		1200	90S	575 V	PC6M001-5	82.5	320	1.25	1.40	58	RF, EU
1.5	1.1	3600	80	230/460 V	BC2M1.5-4	84	278	1.25	1.90	42	RF, EU
		3600	80	575 V	BC2M1.5-5	84	278	1.25	1.52	42	RF, EU
		1800	90S/L	230/460 V	BC4M1.5-4	86.5	364	1.25	2.10	58	RF, EU
		1800	90S/L	575 V	BC4M1.5-5	86.5	364	1.25	1.68	58	RF, EU
2	1.5	3600	90S/L	230/460 V	BC2M002-4	85.5	364	1.25	2.60	58	RF, EU
		3600	90S/L	575 V	BC2M002-5	85.5	364	1.25	2.08	58	RF, EU
		1800	90S/L	230/460 V	BC4M002-4	86.5	364	1.25	2.90	60	RF, EU
		1800	90S/L	575 V	BC4M002-5	86.5	364	1.25	2.32	60	RF, EU
		1200	100L	230/460 V	PC6M002-4	88.5	385	1.25	3.00	125	RF, EU
		1200	100L	575 V	PC6M002-5	88.5	385	1.25	2.40	125	RF, EU
3	2.2	3600	90S/L	230/460 V	BC2M003-4	86.5	364	1.25	3.50	60	RF, EU
		3600	90S/L	575 V	BC2M003-5	86.5	364	1.25	2.80	60	RF, EU
		1800	100L	230/460 V	BC4M003-4	89.5	409	1.25	3.90	124	RF, EU
		1800	100L	575 V	BC4M003-5	89.5	409	1.25	3.12	124	RF, EU
		1200	112M	230/460 V	PC6M003-4	89.5	405	1.25	4.20	136	RF, EU
		1200	112M	575 V	PC6M003-5	89.5	405	1.25	3.40	136	RF, EU
4	3	3600	100L	230/460 V	BC2M004-4	88.5	409	1.25	4.60	124	RF, EU
		3600	100L	575 V	BC2M004-5	88.5	409	1.25	3.68	124	RF, EU
		1800	100L	230/460 V	BC4M004-4	89.5	409	1.25	5.00	124	RF, EU
		1800	100L	575 V	BC4M004-5	89.5	409	1.25	4.00	124	RF, EU
		1200	132S	230/460 V	PC6M004-4	89.5	467	1.25	5.60	204	RF, EU
		1200	132S	575 V	PC6M004-5	89.5	467	1.25	4.48	204	RF, EU
5.5	4	3600	112M	230/460 V	BC2M5.5-4	88.5	402	1.25	5.70	136	RF, EU
		3600	112M	575 V	BC2M5.5-5	88.5	402	1.25	4.56	136	RF, EU
		1800	112M	230/460 V	BC4M5.5-4	89.5	402	1.25	6.30	136	RF, EU
		1800	112M	575 V	BC4M5.5-5	89.5	402	1.25	5.04	136	RF, EU
		1200	132M	230/460 V	PC6M5.5-4	89.5	505	1.25	7.10	220	RF, EU
		1200	132M	575 V	PC6M5.5-5	89.5	505	1.25	5.70	220	RF, EU
7.5	5.5	3600	132S/M	230/460 V	BC2M7.5-4	89.5	484	1.25	8.40	204	RF, EU
		3600	132S/M	575 V	BC2M7.5-5	89.5	484	1.25	6.72	204	RF, EU
		1800	132S/M	230/460 V	BC4M7.5-4	91.7	484	1.25	9.80	204	RF, EU
		1800	132S/M	575 V	BC4M7.5-5	91.7	484	1.25	7.84	204	RF, EU
		1200	132S/M	230/460 V	BC6M7.5-4	91	484	1.25	10.60	220	RF, EU
		1200	132S/M	575 V	BC6M7.5-5	91	484	1.25	8.48	220	RF, EU
10	7.5	3600	132S/M	230/460 V	BC2M010-4	90.2	484	1.25	11.60	204	RF, EU
		3600	132S/M	575 V	BC2M010-5	90.2	484	1.25	9.28	204	RF, EU
		1800	132S/M	230/460 V	BC4M010-4	91.7	484	1.25	13.20	220	RF, EU
		1800	132S/M	575 V	BC4M010-5	91.7	484	1.25	10.56	220	RF, EU
		1200	160M/L	230/460 V	BC6M010-4	91	604	1.25	13.70	320	RF, EU, TM
		1200	160M/L	575 V	BC6M010-5	91	604	1.25	10.96	320	RF, EU, TM
15	11	3600	160M/L	230/460 V	BC2M015-4	91	604	1.25	17.00	320	RF, EU, TM
		3600	160M/L	575 V	BC2M015-5	91	604	1.25	13.60	320	RF, EU, TM
		1800	160M/L	230/460 V	BC4M015-4	92.4	604	1.25	17.80	320	RF, EU, TM
		1800	160M/L	575 V	BC4M015-5	92.4	604	1.25	14.24	320	RF, EU, TM
		1200	160M/L	230/460 V	BC6M015-4	91.7	604	1.25	19.30	374	RF, EU, TM
		1200	160M/L	575 V	BC6M015-5	91.7	604	1.25	15.44	374	RF, EU, TM

Discount Category **18**



## W Series IEC 80-315L - TEFC B3 (Foot Mount) - Cast Iron

HP	Kw	RPM	Frame	Voltage	P/N	FL Eff.	L Dim. (mm)	S.F. 60 Hz	FL Amps	LBS	Notes
20	15	3600	160M/L	230/460 V	BC2M020-4	91	604	1.25	22.20	320	RF, EU, TM
		3600	160M/L	575 V	BC2M020-5	91	604	1.25	17.76	320	RF, EU, TM
		1800	160M/L	230/460 V	BC4M020-4	93	604	1.25	23.30	374	RF, EU, TM
		1800	160M/L	575 V	BC4M020-5	93	604	1.25	18.64	374	RF, EU, TM
		1200	180M/L	230/460 V	BC6M020-4	91.7	663	1.25	25.70	478	RF, EU, TM
		1200	180M/L	575 V	BC6M020-5	91.7	663	1.25	20.56	478	RF, EU, TM
25	18.5	3600	160M/L	230/460 V	BC2M025-4	91.7	604	1.25	27.20	374	RF, EU, TM
		3600	160M/L	575 V	BC2M025-5	91.7	604	1.25	21.76	374	RF, EU, TM
		1800	180M/L	230/460 V	BC4M025-4	93.6	663	1.25	27.90	478	RF, EU, TM
		1800	180M/L	575 V	BC4M025-5	93.6	663	1.25	22.32	478	RF, EU, TM
		1200	200L	230/460 V	BC6M025-4	93	810	1.25	31.90	602	RF, EU, TM
		1200	200L	575 V	BC6M025-5	93	810	1.25	25.52	602	RF, EU, TM
30	22	3600	180M/L	230/460 V	BC2M030-4	91.7	663	1.25	32.40	478	RF, EU, TM
		3600	180M/L	575 V	BC2M030-5	91.7	663	1.25	25.92	478	RF, EU, TM
		1800	180M/L	230/460 V	BC4M030-4	93.6	663	1.25	33.90	478	RF, EU, TM
		1800	180M/L	575 V	BC4M030-5	93.6	663	1.25	27.12	478	RF, EU, TM
		1200	200L	230/460 V	BC6M030-4	93	810	1.25	38.00	650	RF, EU, TM
		1200	200L	575 V	BC6M030-5	93	810	1.25	30.40	650	RF, EU, TM
40	30	3600	200L	230/460 V	BC2M040-4	93	810	1.25	46.00	650	RF, EU, TM
		3600	200L	575 V	BC2M040-5	93	810	1.25	36.80	650	RF, EU, TM
		1800	200L	230/460 V	BC4M040-4	94.1	810	1.25	45.00	650	RF, EU, TM
		1800	200L	575 V	BC4M040-5	94.1	810	1.25	36.00	650	RF, EU, TM
		1200	225M	230/460 V	BC6M040-4	94.1	875	1.25	46.80	1050	RF, EU, TM
		1200	225M	575 V	BC6M040-5	94.1	875	1.25	37.44	1050	RF, EU, TM
50	37	3600	200L	230/460 V	BC2M050-4	93.6	810	1.25	57.00	650	RF, EU, TM
		3600	200L	575 V	BC2M050-5	93.6	810	1.25	45.60	650	RF, EU, TM
		1800	225S	230/460 V	BC4M050-4	94.5	875	1.25	58.00	914	RF, EU, TM
		1800	225S	575 V	BC4M050-5	94.5	875	1.25	46.40	914	RF, EU, TM
		1200	250M	230/460 V	BC6M050-4	94.1	985	1.25	57.60	1384	RF, EU, TM
		1200	250M	575 V	BC6M050-5	94.1	985	1.25	46.08	1384	RF, EU, TM
60	45	3600	225M	230/460 V	BC2M060-4	93.6	885	1.25	66.00	1050	RF, EU, TM
		3600	225M	575 V	BC2M060-5	93.6	885	1.25	52.80	1050	RF, EU, TM
		1800	225M	230/460 V	BC4M060-4	95	915	1.25	68.00	1050	RF, EU, TM
		1800	225M	575 V	BC4M060-5	95	915	1.25	54.40	1050	RF, EU, TM
		1200	<b>*BS-250M</b>	<b>230/460 V</b>	<b>BC6M060-4S</b>	<b>93.6</b>	<b>985</b>	<b>1.25</b>	<b>70.00</b>	<b>1384</b>	<b>RF, BS, TM</b>
		1200	<b>*BS-250M</b>	<b>575 V</b>	<b>BC6M060-5S</b>	<b>93.6</b>	<b>985</b>	<b>1.25</b>	<b>56.00</b>	<b>1384</b>	<b>RF, BS, TM</b>
		1200	280S	230/460 V	BC6M060-4	94.5	1030	1.25	70.00	1512	RF, EU, TM
		1200	280S	575 V	BC6M060-5	94.5	1030	1.25	56.00	1512	RF, EU, TM
75	55	3600	<b>*BS-250S</b>	<b>230/460 V</b>	<b>BC2M075-4S</b>	<b>95.4</b>	<b>985</b>	<b>1.25</b>	<b>79.30</b>	<b>1384</b>	<b>RF, BS, TM</b>
		3600	<b>*BS-250S</b>	<b>575 V</b>	<b>BC2M075-5S</b>	<b>95.4</b>	<b>985</b>	<b>1.25</b>	<b>63.44</b>	<b>1384</b>	<b>RF, BS, TM</b>
		3600	250M	230/460 V	BC2M075-4	93.6	985	1.25	79.30	1384	RF, EU, TM
		3600	250M	575 V	BC2M075-5	93.6	985	1.25	63.44	1384	RF, EU, TM
		1800	<b>*BS-250S</b>	<b>230/460 V</b>	<b>BC4M075-4S</b>	<b>95.4</b>	<b>985</b>	<b>1.25</b>	<b>81.30</b>	<b>1384</b>	<b>RF, BS, TM</b>
		1800	<b>*BS-250S</b>	<b>575 V</b>	<b>BC4M075-5S</b>	<b>95.4</b>	<b>985</b>	<b>1.25</b>	<b>65.04</b>	<b>1384</b>	<b>RF, BS, TM</b>
		1800	250M	230/460 V	BC4M075-4	95.4	985	1.25	81.30	1384	RF, EU, TM
		1800	250M	575 V	BC4M075-5	95.4	985	1.25	65.04	1384	RF, EU, TM
		1200	<b>*BS-280S</b>	<b>230/460 V</b>	<b>BC6M075-4S</b>	<b>94.1</b>	<b>1030</b>	<b>1.25</b>	<b>87.70</b>	<b>1512</b>	<b>RF, BS, TM</b>
		1200	<b>*BS-280S</b>	<b>575 V</b>	<b>BC6M075-5S</b>	<b>94.1</b>	<b>1030</b>	<b>1.25</b>	<b>70.10</b>	<b>1512</b>	<b>RF, BS, TM</b>
		1200	280M	230/460 V	BC6M075-4	94.5	1070	1.25	87.70	1896	RF, EU, TM
		1200	280M	575 V	BC6M075-5	94.5	1070	1.25	70.10	1896	RF, EU, TM

Discount Category **18**

\*Motor Part Numbers Ending in "S" Have British Standard Dimensions



## W Series IEC 80-315L - TEFC B3 (Foot Mount) - Cast Iron

HP	Kw	RPM	Frame	Voltage	P/N	FL Eff.	L Dim. (mm)	S.F. 60 Hz	FL Amps	LBS	Notes
100	75	3600	*BS-250M	230/460 V	BC2M100-4S	94.1	985	1.25	110.00	1384	RF, BS, TM
		3600	*BS-250M	575 V	BC2M100-5S	94.1	985	1.25	88.00	1384	RF, BS, TM
		3600	280S	230/460 V	BC2M100-4	94.1	1030	1.25	110.00	1512	RF, EU, TM
		3600	280S	575 V	BC2M100-5	94.1	1030	1.25	88.00	1512	RF, EU, TM
		1800	*BS-250M	230/460 V	BC4M100-4S	94.1	985	1.25	116.00	1384	RF, BS, TM
		1800	*BS-250M	575 V	BC4M100-5S	94.1	985	1.25	92.80	1384	RF, BS, TM
		1800	280SE	230/460 V	BC4M100-4	95.4	1030	1.25	116.00	1512	RF, EU, TM
		1800	280SE	575 V	BC4M100-5	95.4	1030	1.25	92.80	1512	RF, EU, TM
		1200	*BS-280M	230/460 V	BC6M100-4S	94.5	1070	1.25	115.00	1896	RF, BS, TM
		1200	*BS-280M	575 V	BC6M100-5S	94.5	1070	1.25	92.00	1896	RF, BS, TM
		1200	315S	230/460 V	BC6M100-4	95	1070	1.25	115.00	2354	RF, EU, TM
		1200	315S	575 V	BC6M100-5	95	1070	1.25	92.00	2354	RF, EU, TM
125	90	3600	*BS-280S	460 V	BC2M125-9S	95.4	1030	1.25	137.00	1512	RF, BS, TM
		3600	*BS-280S	575 V	BC2M125-5S	95.4	1030	1.25	109.60	1512	RF, BS, TM
		3600	280M	460 V	BC2M125-9	95	1070	1.25	137.00	1896	RF, EU, TM
		3600	280M	575 V	BC2M125-5	95	1070	1.25	109.60	1896	RF, EU, TM
		1800	*BS-280S	460 V	BC4M125-9S	95.4	1030	1.25	144.00	1512	RF, BS, TM
		1800	*BS-280S	575 V	BC4M125-5S	95.4	1030	1.25	115.20	1512	RF, BS, TM
		1800	280M	460 V	BC4M125-9	95.4	1070	1.25	144.00	1896	RF, EU, TM
		1800	280M	575 V	BC4M125-5	95.4	1070	1.25	115.20	1896	RF, EU, TM
		1200	*BS-315S	460 V	BC6M125-9S	95	1115	1.25	145.00	2354	RF, BS, TM
		1200	*BS-315S	575 V	BC6M125-5S	95	1115	1.25	116.00	2354	RF, BS, TM
		1200	315M	460 V	BC6M125-9	95	1215	1.25	145.00	2533	RF, EU, TM
		1200	315M	575 V	BC6M125-5	95	1215	1.25	116.00	2533	RF, EU, TM
150	110	3600	*BS-280M	460 V	BC2M150-9S	95	1070	1.25	161.00	1896	RF, BS, TM
		3600	*BS-280M	575 V	BC2M150-5S	95	1070	1.25	128.80	1896	RF, BS, TM
		3600	315S	460 V	BC2M150-9	95	1115	1.25	161.00	2354	RF, EU, TM
		3600	315S	575 V	BC2M150-5	95	1115	1.25	128.80	2354	RF, EU, TM
		1800	*BS-280M	460 V	BC4M150-9S	95.4	1070	1.25	170.00	1896	RF, BS, TM
		1800	*BS-280M	575 V	BC4M150-5S	95.4	1070	1.25	136.00	1896	RF, BS, TM
		1800	315S	460 V	BC4M150-9	95.8	1115	1.25	170.00	2354	RF, EU, TM
		1800	315S	575 V	BC4M150-5	95.8	1115	1.25	136.00	2354	RF, EU, TM
		1200	*BS-315M	460 V	BC6M150-9S	95	1215	1.25	170.00	2533	RF, BS, TM
		1200	*BS-315M	575 V	BC6M150-5S	95	1215	1.25	136.00	2533	RF, BS, TM
		1200	315L	460 V	BC6M150-9	95.8	1315	1.25	170.00	2800	RF, EU, TM
		1200	315L	575 V	BC6M150-5	95.8	1315	1.25	136.00	2800	RF, EU, TM
200	150	3600	315M	460 V	BC2M200-9	95.4	1185	1.25	215.00	2533	RF, EU, TM
		3600	315M	575 V	BC2M200-5	95.4	1185	1.25	172.00	2533	RF, EU, TM
		1800	315M	460 V	BC4M200-9	96.2	1215	1.25	221.00	2533	RF, EU, TM
		1800	315M	575 V	BC4M200-5	96.2	1215	1.25	176.80	2533	RF, EU, TM

Discount Category **18**

\*Motor Part Numbers Ending in "S" Have British Standard Dimensions

Larger Ratings Available By Special Order in Both Low and Medium Voltage Designs.  
Please Contact Brook Crompton for Pricing.



**W Series IEC 80-315L - TEFC  
B14 (C-Face With B3 Removable Feet) - Cast Iron**

HP	Kw	RPM	Frame	Voltage	P/N	FL Eff.	L Dim. (mm)	S.F. 60 Hz	FL Amps	LBS	Notes
1	0.75	3600	80	230/460 V	BC2M001-4C	77	278	1.25	1.40	52	RF, EU
		3600	80	575 V	BC2M001-5C	77	278	1.25	1.12	52	RF, EU
		1800	80	230/460 V	BC4M001-4C	85.5	278	1.25	1.50	52	RF, EU
		1800	80	575 V	BC4M001-5C	85.5	278	1.25	1.20	52	RF, EU
		1200	90S	230/460 V	PC6M001-4C	82.5	320	1.25	1.70	68	RF, EU
		1200	90S	575 V	PC6M001-5C	82.5	320	1.25	1.40	68	RF, EU
1.5	1.1	3600	80	230/460 V	BC2M1.5-4C	84	278	1.25	1.90	52	RF, EU
		3600	80	575 V	BC2M1.5-5C	84	278	1.25	1.52	52	RF, EU
		1800	90S/L	230/460 V	BC4M1.5-4C	86.5	364	1.25	2.10	68	RF, EU
		1800	90S/L	575 V	BC4M1.5-5C	86.5	364	1.25	1.68	68	RF, EU
2	1.5	3600	90S/L	230/460 V	BC2M002-4C	85.5	364	1.25	2.60	68	RF, EU
		3600	90S/L	575 V	BC2M002-5C	85.5	364	1.25	2.08	68	RF, EU
		1800	90S/L	230/460 V	BC4M002-4C	86.5	364	1.25	2.90	70	RF, EU
		1800	90S/L	575 V	BC4M002-5C	86.5	364	1.25	2.32	70	RF, EU
		1200	100L	230/460 V	PC6M002-4C	88.5	385	1.25	3.00	135	RF, EU
		1200	100L	575 V	PC6M002-5C	88.5	385	1.25	2.40	135	RF, EU
3	2.2	3600	90S/L	230/460 V	BC2M003-4C	86.5	364	1.25	3.50	70	RF, EU
		3600	90S/L	575 V	BC2M003-5C	86.5	364	1.25	2.80	70	RF, EU
		1800	100L	230/460 V	BC4M003-4C	89.5	409	1.25	3.90	135	RF, EU
		1800	100L	575 V	BC4M003-5C	89.5	409	1.25	3.12	135	RF, EU
		1200	112M	230/460 V	PC6M003-4C	89.5	405	1.25	4.20	146	RF, EU
		1200	112M	575 V	PC6M003-5C	89.5	405	1.25	3.40	146	RF, EU
4	3	3600	100L	230/460 V	BC2M004-4C	88.5	409	1.25	4.60	135	RF, EU
		3600	100L	575 V	BC2M004-5C	88.5	409	1.25	3.68	135	RF, EU
		1800	100L	230/460 V	BC4M004-4C	89.5	409	1.25	5.00	135	RF, EU
		1800	100L	575 V	BC4M004-5C	89.5	409	1.25	4.00	135	RF, EU
		1200	132S	230/460 V	PC6M004-4C	89.5	467	1.25	5.60	216	RF, EU
		1200	132S	575 V	PC6M004-5C	89.5	467	1.25	4.48	216	RF, EU
5.5	4	3600	112M	230/460 V	BC2M5.5-4C	88.5	402	1.25	5.70	146	RF, EU
		3600	112M	575 V	BC2M5.5-5C	88.5	402	1.25	4.56	146	RF, EU
		1800	112M	230/460 V	BC4M5.5-4C	89.5	402	1.25	6.30	146	RF, EU
		1800	112M	575 V	BC4M5.5-5C	89.5	402	1.25	5.04	146	RF, EU
		1200	132M	230/460 V	PC6M5.5-4C	89.5	505	1.25	7.10	232	RF, EU
		1200	132M	575 V	PC6M5.5-5C	89.5	505	1.25	5.70	232	RF, EU
7.5	5.5	3600	132S/M	230/460 V	BC2M7.5-4C	89.5	484	1.25	8.40	216	RF, EU
		3600	132S/M	575 V	BC2M7.5-5C	89.5	484	1.25	6.72	216	RF, EU
		1800	132S/M	230/460 V	BC4M7.5-4C	91.7	484	1.25	9.80	216	RF, EU
		1800	132S/M	575 V	BC4M7.5-5C	91.7	484	1.25	7.84	216	RF, EU
		1200	132S/M	230/460 V	BC6M7.5-4C	91	484	1.25	10.60	232	RF, EU
		1200	132S/M	575 V	BC6M7.5-5C	91	484	1.25	8.48	232	RF, EU
10	7.5	3600	132S/M	230/460 V	BC2M010-4C	90.2	484	1.25	11.60	216	RF, EU
		3600	132S/M	575 V	BC2M010-5C	90.2	484	1.25	9.28	216	RF, EU
		1800	132S/M	230/460 V	BC4M010-4C	91.7	484	1.25	13.20	232	RF, EU
		1800	132S/M	575 V	BC4M010-5C	91.7	484	1.25	10.56	232	RF, EU
		1200	160M/L	230/460 V	BC6M010-4C	91	604	1.25	13.70	332	RF, EU, TM
		1200	160M/L	575 V	BC6M010-5C	91	604	1.25	10.96	332	RF, EU, TM
15	11	3600	160M/L	230/460 V	BC2M015-4C	91	604	1.25	17.00	332	RF, EU, TM
		3600	160M/L	575 V	BC2M015-5C	91	604	1.25	13.60	332	RF, EU, TM
		1800	160M/L	230/460 V	BC4M015-4C	92.4	604	1.25	17.80	332	RF, EU, TM
		1800	160M/L	575 V	BC4M015-5C	92.4	604	1.25	14.24	332	RF, EU, TM
		1200	160M/L	230/460 V	BC6M015-4C	91.7	604	1.25	19.30	386	RF, EU, TM
		1200	160M/L	575 V	BC6M015-5C	91.7	604	1.25	15.44	386	RF, EU, TM

Discount Category **18**



**W Series IEC 80-315L - TEFC  
B14 (C-Face With B3 Removable Feet) - Cast Iron**

HP	Kw	RPM	Frame	Voltage	P/N	FL Eff.	L Dim. (mm)	S.F. 60 Hz	FL Amps	LBS	Notes
20	15	3600	160M/L	230/460 V	BC2M020-4C	91	604	1.25	22.20	332	RF, EU, TM
		3600	160M/L	575 V	BC2M020-5C	91	604	1.25	17.76	332	RF, EU, TM
		1800	160M/L	230/460 V	BC4M020-4C	93	604	1.25	23.30	386	RF, EU, TM
		1800	160M/L	575 V	BC4M020-5C	93	604	1.25	18.64	386	RF, EU, TM
25	18.5	3600	160M/L	230/460 V	BC2M025-4C	91.7	604	1.25	27.20	386	RF, EU, TM
		3600	160M/L	575 V	BC2M025-5C	91.7	604	1.25	21.76	386	RF, EU, TM

**Discount Category 18**

## W Series IEC 80-315L - TEFC B5 (D-Flange With B3 Removable Feet) - Cast Iron

HP	Kw	RPM	Frame	Voltage	P/N	FL Eff.	L Dim. (mm)	S.F. 60 Hz	FL Amps	LBS	Notes
1	0.75	3600	80	230/460 V	BC2M001-4D	77	278	1.25	1.40	52	RF, EU
		3600	80	575 V	BC2M001-5D	77	278	1.25	1.12	52	RF, EU
		1800	80	230/460 V	BC4M001-4D	85.5	278	1.25	1.50	52	RF, EU
		1800	80	575 V	BC4M001-5D	85.5	278	1.25	1.20	52	RF, EU
		1200	90S	230/460 V	PC6M001-4D	82.5	320	1.25	1.70	68	RF, EU
		1200	90S	575 V	PC6M001-5D	82.5	320	1.25	1.40	68	RF, EU
1.5	1.1	3600	80	230/460 V	BC2M1.5-4D	84	278	1.25	1.90	52	RF, EU
		3600	80	575 V	BC2M1.5-5D	84	278	1.25	1.52	52	RF, EU
		1800	90S/L	230/460 V	BC4M1.5-4D	86.5	364	1.25	2.10	68	RF, EU
		1800	90S/L	575 V	BC4M1.5-5D	86.5	364	1.25	1.68	68	RF, EU
2	1.5	3600	90S/L	230/460 V	BC2M002-4D	85.5	364	1.25	2.60	68	RF, EU
		3600	90S/L	575 V	BC2M002-5D	85.5	364	1.25	2.08	68	RF, EU
		1800	90S/L	230/460 V	BC4M002-4D	86.5	364	1.25	2.90	70	RF, EU
		1800	90S/L	575 V	BC4M002-5D	86.5	364	1.25	2.32	70	RF, EU
		1200	100L	230/460 V	PC6M002-4D	88.5	385	1.25	3.00	135	RF, EU
		1200	100L	575 V	PC6M002-5D	88.5	385	1.25	2.40	135	RF, EU
3	2.2	3600	90S/L	230/460 V	BC2M003-4D	86.5	364	1.25	3.50	70	RF, EU
		3600	90S/L	575 V	BC2M003-5D	86.5	364	1.25	2.80	70	RF, EU
		1800	100L	230/460 V	BC4M003-4D	89.5	409	1.25	3.90	135	RF, EU
		1800	100L	575 V	BC4M003-5D	89.5	409	1.25	3.12	135	RF, EU
		1200	112M	230/460 V	PC6M003-4D	89.5	405	1.25	4.20	146	RF, EU
		1200	112M	575 V	PC6M003-5D	89.5	405	1.25	3.40	146	RF, EU
4	3	3600	100L	230/460 V	BC2M004-4D	88.5	409	1.25	4.60	135	RF, EU
		3600	100L	575 V	BC2M004-5D	88.5	409	1.25	3.68	135	RF, EU
		1800	100L	230/460 V	BC4M004-4D	89.5	409	1.25	5.00	135	RF, EU
		1800	100L	575 V	BC4M004-5D	89.5	409	1.25	4.00	135	RF, EU
		1200	132S	230/460 V	PC6M004-4D	89.5	467	1.25	5.60	216	RF, EU
		1200	132S	575 V	PC6M004-5D	89.5	467	1.25	4.48	216	RF, EU
5.5	4	3600	112M	230/460 V	BC2M5.5-4D	88.5	402	1.25	5.70	146	RF, EU
		3600	112M	575 V	BC2M5.5-5D	88.5	402	1.25	4.56	146	RF, EU
		1800	112M	230/460 V	BC4M5.5-4D	89.5	402	1.25	6.30	146	RF, EU
		1800	112M	575 V	BC4M5.5-5D	89.5	402	1.25	5.04	146	RF, EU
		1200	132M	230/460 V	PC6M5.5-4D	89.5	505	1.25	7.10	232	RF, EU
		1200	132M	575 V	PC6M5.5-5D	89.5	505	1.25	5.70	232	RF, EU
7.5	5.5	3600	132S/M	230/460 V	BC2M7.5-4D	89.5	484	1.25	8.40	216	RF, EU
		3600	132S/M	575 V	BC2M7.5-5D	89.5	484	1.25	6.72	216	RF, EU
		1800	132S/M	230/460 V	BC4M7.5-4D	91.7	484	1.25	9.80	216	RF, EU
		1800	132S/M	575 V	BC4M7.5-5D	91.7	484	1.25	7.84	216	RF, EU
		1200	132S/M	230/460 V	BC6M7.5-4D	91	484	1.25	10.60	232	RF, EU
		1200	132S/M	575 V	BC6M7.5-5D	91	484	1.25	8.48	232	RF, EU
10	7.5	3600	132S/M	230/460 V	BC2M010-4D	90.2	484	1.25	11.60	216	RF, EU
		3600	132S/M	575 V	BC2M010-5D	90.2	484	1.25	9.28	216	RF, EU
		1800	132S/M	230/460 V	BC4M010-4D	91.7	484	1.25	13.20	232	RF, EU
		1800	132S/M	575 V	BC4M010-5D	91.7	484	1.25	10.56	232	RF, EU
		1200	160M/L	230/460 V	BC6M010-4D	91	604	1.25	13.70	332	RF, EU, TM
		1200	160M/L	575 V	BC6M010-5D	91	604	1.25	10.96	332	RF, EU, TM
15	11	3600	160M/L	230/460 V	BC2M015-4D	91	604	1.25	17.00	332	RF, EU, TM
		3600	160M/L	575 V	BC2M015-5D	91	604	1.25	13.60	332	RF, EU, TM
		1800	160M/L	230/460 V	BC4M015-4D	92.4	604	1.25	17.80	332	RF, EU, TM
		1800	160M/L	575 V	BC4M015-5D	92.4	604	1.25	14.24	332	RF, EU, TM
		1200	160M/L	230/460 V	BC6M015-4D	91.7	604	1.25	19.30	386	RF, EU, TM
		1200	160M/L	575 V	BC6M015-5D	91.7	604	1.25	15.44	386	RF, EU, TM

Discount Category **18**



**W Series IEC 80-315L - TEFC -  
B5 (D-Flange With B3 Removable Feet) - Cast Iron**

HP	Kw	RPM	Frame	Voltage	P/N	FL Eff.	L Dim. (mm)	S.F. 60 Hz	FL Amps	LBS	Notes
20	15	3600	160M/L	230/460 V	BC2M020-4D	91	604	1.25	22.20	332	RF, EU, TM
		3600	160M/L	575 V	BC2M020-5D	91	604	1.25	17.76	332	RF, EU, TM
		1800	160M/L	230/460 V	BC4M020-4D	93	604	1.25	23.30	386	RF, EU, TM
		1800	160M/L	575 V	BC4M020-5D	93	604	1.25	18.64	386	RF, EU, TM
		1200	200L	230/460 V	BC6M020-4D	91.7	663	1.25	25.70	450	RF, EU, TM
		1200	200L	575 V	BC6M020-5D	91.7	663	1.25	20.60	450	RF, EU, TM
25	18.5	3600	160M/L	230/460 V	BC2M025-4D	91.7	604	1.25	27.20	374	RF, EU, TM
		3600	160M/L	575 V	BC2M025-5D	91.7	604	1.25	21.76	374	RF, EU, TM
		1800	180M/L	230/460 V	BC4M025-4D	93.6	663	1.25	27.90	478	RF, EU, TM
		1800	180M/L	575 V	BC4M025-5D	93.6	663	1.25	22.32	478	RF, EU, TM
		1200	200L	230/460 V	BC6M025-4D	93	810	1.25	31.90	675	RF, EU, TM
		1200	200L	575 V	BC6M025-5D	93	810	1.25	25.50	675	RF, EU, TM
30	22	3600	180M/L	230/460 V	BC2M030-4D	91.7	663	1.25	32.40	478	RF, EU, TM
		3600	180M/L	575 V	BC2M030-5D	91.7	663	1.25	25.92	478	RF, EU, TM
		1800	180M/L	230/460 V	BC4M030-4D	93.6	663	1.25	33.90	478	RF, EU, TM
		1800	180M/L	575 V	BC4M030-5D	93.6	663	1.25	27.12	478	RF, EU, TM
		1200	200L	230/460 V	BC6M030-4D	93	810	1.25	38.00	675	RF, EU, TM
		1200	200L	575 V	BC6M030-5D	93	810	1.25	30.40	675	RF, EU, TM
40	30	3600	200L	230/460 V	BC2M040-4D	93	810	1.25	46.00	675	RF, EU, TM
		3600	200L	575 V	BC2M040-5D	93	810	1.25	36.80	675	RF, EU, TM
		1800	200L	230/460 V	BC4M040-4D	94.1	810	1.25	45.00	675	RF, EU, TM
		1800	200L	575 V	BC4M040-5D	94.1	810	1.25	36.00	675	RF, EU, TM
		1200	225M	230/460 V	BC6M040-4D	94.1	875	1.25	46.80	1075	RF, EU, TM
		1200	225M	575 V	BC6M040-5D	94.1	875	1.25	37.40	1075	RF, EU, TM
50	37	3600	200L	230/460 V	BC2M050-4D	93.6	810	1.25	57.00	675	RF, EU, TM
		3600	200L	575 V	BC2M050-5D	93.6	810	1.25	45.60	675	RF, EU, TM
		1800	225S	230/460 V	BC4M050-4D	94.5	875	1.25	58.00	939	RF, EU, TM
		1800	225S	575 V	BC4M050-5D	94.5	875	1.25	46.40	939	RF, EU, TM
		1200	250M	230/460 V	BC6M050-4D	94.1	985	1.25	57.60	1439	RF, EU, TM
		1200	250M	575 V	BC6M050-5D	94.1	985	1.25	46.10	1439	RF, EU, TM
60	45	3600	225M	230/460 V	BC2M060-4D	93.6	885	1.25	66.00	1075	RF, EU, TM
		3600	225M	575 V	BC2M060-5D	93.6	885	1.25	52.80	1075	RF, EU, TM
		1800	225M	230/460 V	BC4M060-4D	95	915	1.25	68.00	1075	RF, EU, TM
		1800	225M	575 V	BC4M060-5D	95	915	1.25	54.40	1075	RF, EU, TM
		1200	<b>*BS-250M</b>	<b>230/460 V</b>	<b>BC6M060-4SD</b>	<b>93.6</b>	<b>985</b>	<b>1.25</b>	<b>70.00</b>	<b>1439</b>	<b>RF, BS, TM</b>
		1200	<b>*BS-250M</b>	<b>575 V</b>	<b>BC6M060-5SD</b>	<b>93.6</b>	<b>985</b>	<b>1.25</b>	<b>56.00</b>	<b>1439</b>	<b>RF, BS, TM</b>
		1200	280S	230/460 V	BC6M060-4D	94.5	1030	1.25	70.00	1567	RF, EU, TM
		1200	280S	575 V	BC6M060-5D	94.5	1030	1.25	56.00	1567	RF, EU, TM
75	55	3600	<b>*BS-250S</b>	<b>230/460 V</b>	<b>BC2M075-4SD</b>	<b>95.4</b>	<b>985</b>	<b>1.25</b>	<b>79.30</b>	<b>1439</b>	<b>RF, BS, TM</b>
		3600	<b>*BS-250S</b>	<b>575 V</b>	<b>BC2M075-5SD</b>	<b>95.4</b>	<b>985</b>	<b>1.25</b>	<b>63.44</b>	<b>1439</b>	<b>RF, BS, TM</b>
		3600	250M	230/460 V	BC2M075-4D	93.6	985	1.25	79.30	1439	RF, EU, TM
		3600	250M	575 V	BC2M075-5D	93.6	985	1.25	63.44	1439	RF, EU, TM
		1800	<b>*BS-250S</b>	<b>230/460 V</b>	<b>BC4M075-4SD</b>	<b>95.4</b>	<b>985</b>	<b>1.25</b>	<b>81.30</b>	<b>1439</b>	<b>RF, BS, TM</b>
		1800	<b>*BS-250S</b>	<b>575 V</b>	<b>BC4M075-5SD</b>	<b>95.4</b>	<b>985</b>	<b>1.25</b>	<b>65.04</b>	<b>1439</b>	<b>RF, BS, TM</b>
		1800	250M	230/460 V	BC4M075-4D	95.4	985	1.25	81.30	1439	RF, EU, TM
		1800	250M	575 V	BC4M075-5D	95.4	985	1.25	65.04	1439	RF, EU, TM
		1200	<b>*BS-280S</b>	<b>230/460 V</b>	<b>BC6M075-4SD</b>	<b>94.1</b>	<b>1030</b>	<b>1.25</b>	<b>87.70</b>	<b>1567</b>	<b>RF, BS, TM</b>
		1200	<b>*BS-280S</b>	<b>575 V</b>	<b>BC6M075-5SD</b>	<b>94.1</b>	<b>1030</b>	<b>1.25</b>	<b>70.10</b>	<b>1567</b>	<b>RF, BS, TM</b>
		1200	280M	230/460 V	BC6M075-4D	94.5	1070	1.25	87.70	1951	RF, EU, TM
		1200	280M	575 V	BC6M075-5D	94.5	1070	1.25	70.10	1951	RF, EU, TM

Discount Category **18**

\*Motor Part Numbers Ending in "SD" Have British Standard Dimensions



## W Series IEC 80-315L - TEFC B5 (D-Flange With B3 Removable Feet) - Cast Iron

HP	Kw	RPM	Frame	Voltage	P/N	FL Eff.	L Dim. (mm)	S.F. 60 Hz	FL Amps	LBS	Notes
100	75	3600	<i>*BS-250M</i>	230/460 V	<i>BC2M100-4SD</i>	94.1	985	1.25	110.00	1439	RF, BS, TM
		3600	<i>*BS-250M</i>	575 V	<i>BC2M100-5SD</i>	94.1	985	1.25	88.00	1439	RF, BS, TM
		3600	280S	230/460 V	BC2M100-4D	94.1	1030	1.25	110.00	1567	RF, EU, TM
		3600	280S	575 V	BC2M100-5D	94.1	1030	1.25	88.00	1567	RF, EU, TM
		1800	<i>*BS-250M</i>	230/460 V	<i>BC4M100-4SD</i>	94.1	985	1.25	116.00	1439	RF, BS, TM
		1800	<i>*BS-250M</i>	575 V	<i>BC4M100-5SD</i>	94.1	985	1.25	92.80	1439	RF, BS, TM
		1800	280SE	230/460 V	BC4M100-4D	95.4	1030	1.25	116.00	1567	RF, EU, TM
		1800	280SE	575 V	BC4M100-5D	95.4	1030	1.25	92.80	1567	RF, EU, TM
		1200	<i>*BS-280M</i>	230/460 V	<i>BC6M100-4SD</i>	94.5	1070	1.25	115.00	1951	RF, BS, TM
		1200	<i>*BS-280M</i>	575 V	<i>BC6M100-5SD</i>	94.5	1070	1.25	92.00	1951	RF, BS, TM
		1200	315S	230/460 V	BC6M100-4D	95	1070	1.25	115.00	2419	RF, EU, TM
		1200	315S	575 V	BC6M100-5D	95	1070	1.25	92.00	2419	RF, EU, TM
125	90	3600	<i>*BS-280S</i>	460 V	<i>BC2M125-9SD</i>	95.4	1030	1.25	137.00	1567	RF, BS, TM
		3600	<i>*BS-280S</i>	575 V	<i>BC2M125-5SD</i>	95.4	1030	1.25	109.60	1567	RF, BS, TM
		3600	280M	460 V	BC2M125-9D	95	1070	1.25	137.00	1951	RF, EU, TM
		3600	280M	575 V	BC2M125-5D	95	1070	1.25	109.60	1951	RF, EU, TM
		1800	<i>*BS-280S</i>	460 V	<i>BC4M125-9SD</i>	95.4	1030	1.25	144.00	1567	RF, BS, TM
		1800	<i>*BS-280S</i>	575 V	<i>BC4M125-5SD</i>	95.4	1030	1.25	115.20	1567	RF, BS, TM
		1800	280M	460 V	BC4M125-9D	95.4	1070	1.25	144.00	1951	RF, EU, TM
		1800	280M	575 V	BC4M125-5D	95.4	1070	1.25	115.20	1951	RF, EU, TM
		1200	<i>*BS-315S</i>	460 V	<i>BC6M125-9SD</i>	95	1115	1.25	145.00	2419	RF, BS, TM
		1200	<i>*BS-315S</i>	575 V	<i>BC6M125-5SD</i>	95	1115	1.25	116.00	2419	RF, BS, TM
		1200	315M	460 V	BC6M125-9D	95	1215	1.25	145.00	2598	RF, EU, TM
		1200	315M	575 V	BC6M125-5D	95	1215	1.25	116.00	2598	RF, EU, TM
150	110	3600	<i>*BS-280M</i>	460 V	<i>BC2M150-9SD</i>	95	1070	1.25	161.00	1951	RF, BS, TM
		3600	<i>*BS-280M</i>	575 V	<i>BC2M150-5SD</i>	95	1070	1.25	128.80	1951	RF, BS, TM
		3600	315S	460 V	BC2M150-9D	95	1115	1.25	161.00	2419	RF, EU, TM
		3600	315S	575 V	BC2M150-5D	95	1115	1.25	128.80	2419	RF, EU, TM
		1800	<i>*BS-280M</i>	460 V	<i>BC4M150-9SD</i>	95.4	1070	1.25	170.00	1951	RF, BS, TM
		1800	<i>*BS-280M</i>	575 V	<i>BC4M150-5SD</i>	95.4	1070	1.25	136.00	1951	RF, BS, TM
		1800	315S	460 V	BC4M150-9D	95.8	1115	1.25	170.00	2419	RF, EU, TM
		1800	315S	575 V	BC4M150-5D	95.8	1115	1.25	136.00	2419	RF, EU, TM
		1200	<i>*BS-315M</i>	460 V	<i>BC6M150-9SD</i>	95	1215	1.25	170.00	2598	RF, BS, TM
		1200	<i>*BS-315M</i>	575 V	<i>BC6M150-5SD</i>	95	1215	1.25	136.00	2598	RF, BS, TM
		1200	315L	460 V	BC6M150-9D	95.8	1315	1.25	170.00	2865	RF, EU, TM
		1200	315L	575 V	BC6M150-5D	95.8	1315	1.25	136.00	2865	RF, EU, TM
200	150	3600	315M	460 V	BC2M200-9D	95.4	1185	1.25	215.00	2598	RF, EU, TM
		3600	315M	575 V	BC2M200-5D	95.4	1185	1.25	172.00	2598	RF, EU, TM
		1800	315M	460 V	BC4M200-9D	96.2	1215	1.25	221.00	2598	RF, EU, TM
		1800	315M	575 V	BC4M200-5D	96.2	1215	1.25	176.80	2598	RF, EU, TM

Discount Category **18**

**\*Motor Part Numbers Ending in "SD" Have British Standard Dimensions**

**Larger Ratings Available By Special Order in Both Low and Medium Voltage Designs.  
Please Contact Brook Crompton for Pricing.**



## IEC Euronorm TEFC Dimensions Frame Sizes 63 - 315

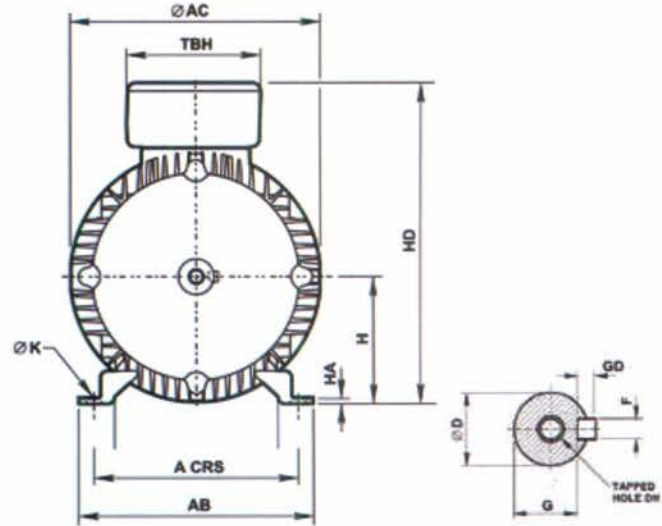
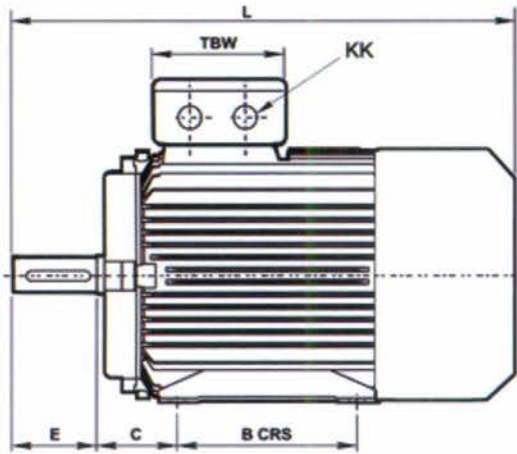

**B3 (FOOT MOUNTED)**

Frame Size	FOOT MOUNTING				SHAFT					GENERAL						
	H	A	B	C	D	E	F	G	K	AB	HD	AC	TBW	TBH	KK	
63	63	100	80	40	11	23	4	8.5	7	119	163	126	86	86	1 X CM20	
71	71	112	90	45	14	30	5	11	7	131	163	140	86	86	1 X CM20	
80M	80	125	100	50	19	40	6	15.5	10	157	212	157	86	86	1 X CM20	
90S	90	140	100	56	24	50	8	20	10	164	225	178	86	86	1 X CM20	
90L	90	140	125	56	24	50	8	20	10	164	225	178	86	86	1 X CM20	
100L	100	160	140	63	28	60	8	24	12	164	267	178	127	127	2 X CM20	
112M	112	190	140	70	28	60	8	24	12	218	279	215	127	127	2 X CM25	
132S	132	216	140	89	38	80	10	33	12	242	332	255	127	127	2 X CM25	
132M	132	216	178	89	38	80	10	33	12	242	332	255	127	127	2 X CM25	
160M	160	254	210	108	42	110	12	37	15	304	400	312	140	140	2 X CM32	
160L	160	254	254	108	42	110	12	37	15	304	400	312	140	140	2 X CM32	
180M	180	279	241	121	48	110	14	42.5	15	329	400	354	140	140	2 X CM32	
180L	180	279	279	121	48	110	14	42.5	15	329	400	354	140	140	2 X CM32	
200L	200	318	305	133	55	110	16	49	19	386	525	410	220	161	-	
225S	2	225	356	286	149	55	110	16	49	M16	426	550	410	220	161	-
	4,8					60	140	18	53							
225M	2	225	356	311	149	55	110	16	49	M16	426	570	448	220	161	-
	4,6,8					60	140	18	53							
250M	2	250	406	349	168	60	140	18	53	M20	482	595	448	220	161	-
	4,6,8					65	140	18	58							
280S	2	280	457	368	190	65	140	18	58	M20	540	655	508	220	161	-
	4,6,8					75	140	20	67.5							
280M	2	280	457	419	190	65	140	18	58	M20	540	655	508	220	161	-
	4,6,8					75	140	20	67.5							
315S	2	315	508	406	216	65	170	18	58	M24	597	845	563	330	326	-
	4,6,8					80	170	20	71							
315M	2	315	508	457	216	65	170	18	58	M24	597	845	563	330	326	-
	4,6,8					80	170	20	71							
315L	2	315	508	508	216	65	170	18	58	M24	597	875	640	330	326	-
	4,6,8					80	170	20	71							

# IEC Euronorm TEFC Dimensions

## TEFC Dimensions Frame Sizes 63 - 315

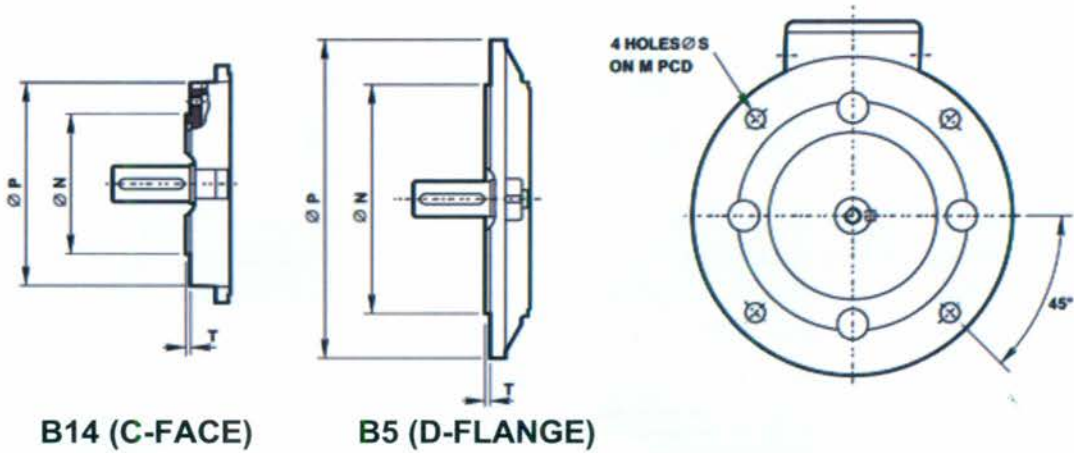

Frame Size	D FLANGE (B5)					C FACE (B14)				
	N	M	P	S	T	N	M	P	S	T
63	95	115	140	10	3	60	75	90	M5	2.5
71	110	130	160	10	3.5	70	85	105	M6	2.5
80M	130	165	200	12	3.5	80	100	120	M6	3.0
90S	130	165	200	12	3.5	95	115	140	M8	3.0
90L	130	165	200	12	3.5	95	115	140	M8	3.0
100L	180	215	250	14.5	4	110	130	160	M8	3.5
112M	180	215	250	14.5	4	110	130	160	M8	3.5
132S	230	265	300	14.5	4	130	165	200	M10	3.5
132M	230	265	300	14.5	4	130	165	200	M10	3.5
160M	250	300	350	18.5	5	180	215	250	M12	4.0
160L	250	300	350	18.5	5	180	215	250	M12	4.0
180M	250	300	350	18.5	5	-	-	-	-	-
180L	250	300	350	18.5	5	-	-	-	-	-
200L	300	350	400	19	5	-	-	-	-	-
225S	350	400	450	19	5	-	-	-	-	-
225M	350	400	450	19	5	-	-	-	-	-
250M	450	500	550	19	5	-	-	-	-	-
280S	450	500	550	19	5	-	-	-	-	-
280M	450	500	550	19	5	-	-	-	-	-
315S	450	500	550	19	5	-	-	-	-	-
315M	550	600	650	24	6	-	-	-	-	-
315L	550	600	650	24	6	-	-	-	-	-



## IP (Ingress Protection) Definition

### Definition IP (Ingress Protection) IEC Metric Motors

IP 5 5

Protection Against Solid Objects			Protection Against Liquids		
#	Brief Description*	Definitions	#	Brief Description*	Definitions
0	Non-protected machines	No special protection	0	Non-protected machines	No special protection
1	Machine protected against solid objects greater than 50 mm**	Accidental or inadvertent contact with or approach to live and moving parts inside the enclosure by a large surface of the human body, such as a hand (but no protection against deliberate access). Ingress of solid objects exceeding 50 mm in diameter	1	Machine protected against dripping water	Dripping water (vertically falling drops) shall have no harmful effect.
2	Machine protected against solid objects greater than 12 mm**	Contact by fingers or similar objects not exceeding 80 mm in length with or approach to live or moving parts inside the enclosure. Ingress of solid objects exceeding 12 mm in diameter.	2	Machine protected against dripping water when tilted up to 15°	Vertically dripping water shall have no harmful effect when the machine is tilted in any angle up to 15° from its normal position
3	Machine protected against solid objects greater than 2.5 mm**	Contact with or approach to live or moving parts inside the enclosure by tools or wires exceeding 2.5 mm in diameter. Ingress of solid objects exceeding 1 mm in diameter.	3	Machine protected against spraying water	Vertically dripping water shall have no harmful effect when the machine is tilted in any angle up to 15° from its normal position
4	Machine protected against solid objects greater than 1mm**	Contact with or approach to live or moving parts inside the enclosure by wires or strips of thickness greater than 1 mm in diameter.	4	Machine protected against splashing water	Water falling as a spray at any angle up to 60° from the vertical shall have no harmful effect
5	Dust-protected machine†	Contact with or approach to live or moving parts inside the enclosure. Ingress of dust is not totally prevented but dust does not enter in sufficient quantity to interfere with satisfactory operation of the machine.	5	Machine protected against water jets	Water projected by a nozzle against the machine from any direction shall have no harmful effect.
6	Dust-tight machine†	Contact with or approach to live or moving parts inside the enclosure. No ingress of dust	6	Machine protected against heavy seas	Water from heavy seas or water projected in powerful jets shall not enter the machine in harmful quantities.

\* The brief description given in column 2 on this table should not be used to specify the form of protection.

\*\* Machines assigned a first characteristic number 1,2,3 or 4 will exclude both regularly or irregularly shaped solid objects provided that three normally perpendicular dimensions of the object exceed the appropriate figure in column "Definition".

† The degree of protection against dust defined by this standard is a general one. When the nature (dimensions of particles, their nature, for instance fibrous particles) is specified, test conditions should be determined by an agreement between manufacturer and user.

# Mounting Codes

## IEC Mounting Codes

Horizontal shaft:



IM B3  
IM 1001  
foot mounted



IM B5  
IM 3001  
flange at DE  
no feet



IM B6  
IM 1051  
foot wall mounted with  
feet on left-hand side  
when viewed from DE



IM B7  
IM 1061  
foot wall mounted with  
feet on right-hand side  
when viewed from DE



IM B8  
IM 1071  
ceiling mounted  
with feet  
above motor



IM B14  
IM 3601  
face at DE  
no feet

Vertical shaft:



IM V1  
IM 3011  
flange at DE  
shaft down  
no feet



IM V3  
IM 3031  
flange at DE  
shaft up  
no feet



IM V5  
IM 1011  
vertical foot  
wall mounted  
shaft down



IM V6  
IM 1031  
vertical foot  
wall mounted  
shaft up



IM V18  
IM 3611  
face at DE  
shaft down  
no feet



IM V19  
IM 3631  
face at DE  
shaft up  
no feet

## NEMA Mounting Codes

### FLOOR MOUNTINGS



ASSEMBLY F-1

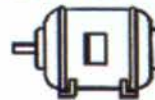

ASSEMBLY F-2



ASSEMBLY F-3

### WALL MOUNTINGS



ASSEMBLY W-1



ASSEMBLY W-2



ASSEMBLY W-3

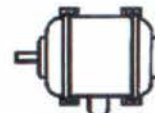

ASSEMBLY W-4



ASSEMBLY W-5



ASSEMBLY W-6



ASSEMBLY W-7



ASSEMBLY W-8



ASSEMBLY W-9



ASSEMBLY W-10



ASSEMBLY W-11



ASSEMBLY W-12

### CEILING MOUNTINGS



ASSEMBLY C-1



ASSEMBLY C-2



ASSEMBLY C-3



**W Series NEMA 56/56C, 3 Phase - TEFC  
Cast Aluminum Construction**



Lightweight High Performance  
Cast Aluminum Frames. Features  
Include:

- NEMA MG1-Part 31 inverter duty  
15:1 constant torque, 20:1  
variable torque
- 1.25 service factor at 60Hz, 1.0  
service factor at 50Hz
- Class F insulation with class B  
temperature rise
- Removable/ repositionable feet  
for easy conversion to F1, F2, F3  
(F0), or round body configuration
- IP55 degree of protection for  
washdown duty enclosure
- Full contact shaft seals inside  
both brackets for increased  
protection against contaminants
- Dual rated 60/50Hz at same HP
- Cast aluminum conduit box with  
drilled and tapped entry is  
rotatable in 90 degree  
increments
- CSA approved for Class I;  
Division 2; Groups A, B, C & D,  
Zone 2; Groups IIA & IIB T3 on  
sine wave power
- Internal tropicproof
- 1 year warranty

**Notes:**

RF - Removable Feet

EI - Does Not Meet EISA Efficiency Legislation

## W Series, NEMA 56, 3 Phase - TEFC Foot Mounted - Cast Aluminum

HP	RPM	Frame	Voltage	P/N	FL Eff.	C Dim. (IN)	S.F. 60 Hz	FL Amps	LBS	Notes
0.25	1800	56	208-230/460 V	BF4N.25-2	66	11.54	1.25	0.50	18	RF
	1800	56	575 V	BF4N.25-5	66	11.54	1.25	0.40	18	RF
	1200	56	208-230/460 V	BF6N.25-2	72.5	11.54	1.25	0.45	18	RF
	1200	56	575 V	BF6N.25-5	72.5	11.54	1.25	0.36	18	RF
	900	56	208-230/460 V	BF8N.25-2	57.5	11.54	1.25	0.87	18	RF
	900	56	575 V	BF8N.25-5	57.5	11.54	1.25	0.70	18	RF
0.33	3600	56	208-230/460 V	BF2N.33-2	74	11.54	1.25	0.49	18	RF
	3600	56	575 V	BF2N.33-5	74	11.54	1.25	0.39	18	RF
	1800	56	208-230/460 V	BF4N.33-2	68	11.54	1.25	0.66	18	RF
	1800	56	575 V	BF4N.33-5	68	11.54	1.25	0.53	18	RF
	1200	56	208-230/460 V	BF6N.33-2	72.5	11.54	1.25	0.62	18	RF
	1200	56	575 V	BF6N.33-5	72.5	11.54	1.25	0.49	18	RF
	900	56	208-230/460 V	BF8N.33-2	70	11.54	1.25	0.70	18	RF
	900	56	575 V	BF8N.33-5	70	11.54	1.25	0.60	18	RF
0.50	3600	56	208-230/460 V	BF2N.50-2	74	11.54	1.25	0.72	18	RF
	3600	56	575 V	BF2N.50-5	74	11.54	1.25	0.58	18	RF
	1800	56	208-230/460 V	BF4N.50-2	68	11.54	1.25	0.98	18	RF
	1800	56	575 V	BF4N.50-5	68	11.54	1.25	0.78	18	RF
	1200	56	208-230/460 V	BF6N.50-2	74	11.54	1.25	0.90	18	RF
	1200	56	575 V	BF6N.50-5	74	11.54	1.25	0.72	18	RF
	900	56	208-230/460 V	BF8N.50-2	72.5	11.54	1.25	1.10	18	RF
	900	56	575 V	BF8N.50-5	72.5	11.54	1.25	0.85	18	RF
0.75	3600	56	208-230/460 V	BF2N.75-2	75	11.54	1.25	1.15	20	RF
	3600	56	575 V	BF2N.75-5	75	11.54	1.25	0.92	20	RF
	1800	56	208-230/460 V	BF4N.75-2	75.5	11.54	1.25	1.28	20	RF
	1800	56	575 V	BF4N.75-5	75.5	11.54	1.25	1.02	20	RF
	1200	56	208-230/460 V	BF6N.75-2	72.5	11.54	1.25	1.36	20	RF
	1200	56	575 V	BF6N.75-5	72.5	11.54	1.25	1.09	20	RF
1	3600	56	208-230/460 V	BF2N001-2	75	11.54	1.25	1.51	24	RF
	3600	56	575 V	BF2N001-5	75	11.54	1.25	1.21	24	RF
	1800	56	208-230/460 V	BF4N001-2	73	11.54	1.25	1.67	24	RF, EI
	1800	56	575 V	BF4N001-5	73	11.54	1.25	1.34	24	RF, EI
1.5	3600	56	208-230/460 V	BF2N1.5-2	77	11.54	1.25	2.11	24	RF, EI
	3600	56	575 V	BF2N1.5-5	77	11.54	1.25	1.69	24	RF, EI
	1800	56	208-230/460 V	BF4N1.5-2	75	11.54	1.25	2.40	24	RF, EI
	1800	56	575 V	BF4N1.5-5	75	11.54	1.25	1.91	24	RF, EI

Discount Category **10**



**W Series NEMA 56C, 3 Phase - TEFC  
C-Face With Removable Feet - Cast Aluminum**

HP	RPM	Frame	Voltage	P/N	FL Eff.	C Dim. (IN)	S.F. 60 Hz	FL Amps	LBS	Notes
0.25	1800	56C	208-230/460 V	BF4N.25-2C	66	11.54	1.25	0.50	24	RF
	1800	56C	575 V	BF4N.25-5C	66	11.54	1.25	0.40	24	RF
	1200	56C	208-230/460 V	BF6N.25-2C	72.5	11.54	1.25	0.45	24	RF
	1200	56C	575 V	BF6N.25-5C	72.5	11.54	1.25	0.36	24	RF
	900	56C	208-230/460 V	BF8N.25-2C	57.5	11.54	1.25	0.87	24	RF
	900	56C	575 V	BF8N.25-5C	57.5	11.54	1.25	0.70	24	RF
0.33	3600	56C	208-230/460 V	BF2N.33-2C	74	11.54	1.25	0.49	24	RF
	3600	56C	575 V	BF2N.33-5C	74	11.54	1.25	0.39	24	RF
	1800	56C	208-230/460 V	BF4N.33-2C	68	11.54	1.25	0.66	24	RF
	1800	56C	575 V	BF4N.33-5C	68	11.54	1.25	0.53	24	RF
	1200	56C	208-230/460 V	BF6N.33-2C	72.5	11.54	1.25	0.62	24	RF
	1200	56C	575 V	BF6N.33-5C	72.5	11.54	1.25	0.49	24	RF
	900	56C	208-230/460 V	BF8N.33-2C	70	11.54	1.25	0.70	24	RF
	900	56C	575 V	BF8N.33-5C	70	11.54	1.25	0.60	24	RF
0.50	3600	56C	208-230/460 V	BF2N.50-2C	74	11.54	1.25	0.72	24	RF
	3600	56C	575 V	BF2N.50-5C	74	11.54	1.25	0.58	24	RF
	1800	56C	208-230/460 V	BF4N.50-2C	68	11.54	1.25	0.98	24	RF
	1800	56C	575 V	BF4N.50-5C	68	11.54	1.25	0.78	24	RF
	1200	56C	208-230/460 V	BF6N.50-2C	74	11.54	1.25	0.90	24	RF
	1200	56C	575 V	BF6N.50-5C	74	11.54	1.25	0.72	24	RF
	900	56C	208-230/460 V	BF8N.50-2C	72.5	11.54	1.25	1.10	24	RF
	900	56C	575 V	BF8N.50-5C	72.5	11.54	1.25	0.85	24	RF
0.75	3600	56C	208-230/460 V	BF2N.75-2C	75	11.54	1.25	1.15	26	RF
	3600	56C	575 V	BF2N.75-5C	75	11.54	1.25	0.92	26	RF
	1800	56C	208-230/460 V	BF4N.75-2C	75.5	11.54	1.25	1.28	26	RF
	1800	56C	575 V	BF4N.75-5C	75.5	11.54	1.25	1.02	26	RF
	1200	56C	208-230/460 V	BF6N.75-2C	72.5	11.54	1.25	1.36	26	RF
	1200	56C	575 V	BF6N.75-5C	72.5	11.54	1.25	1.09	26	RF
1	3600	56C	208-230/460 V	BF2N001-2C	75	11.54	1.25	1.51	28	RF
	3600	56C	575 V	BF2N001-5C	75	11.54	1.25	1.21	28	RF
	1800	56C	208-230/460 V	BF4N001-2C	73	11.54	1.25	1.67	28	RF, EI
	1800	56C	575 V	BF4N001-5C	73	11.54	1.25	1.34	28	RF, EI
1.5	3600	56C	208-230/460 V	BF2N1.5-2C	77	11.54	1.25	2.11	28	RF, EI
	3600	56C	575 V	BF2N1.5-5C	77	11.54	1.25	1.69	28	RF, EI
	1800	56C	208-230/460 V	BF4N1.5-2C	75	11.54	1.25	2.40	28	RF, EI
	1800	56C	575 V	BF4N1.5-5C	75	11.54	1.25	1.91	28	RF, EI

Discount Category **10**

**W Series NEMA 143T-286T, 3 Phase - TEFC  
Cast Aluminum Construction**

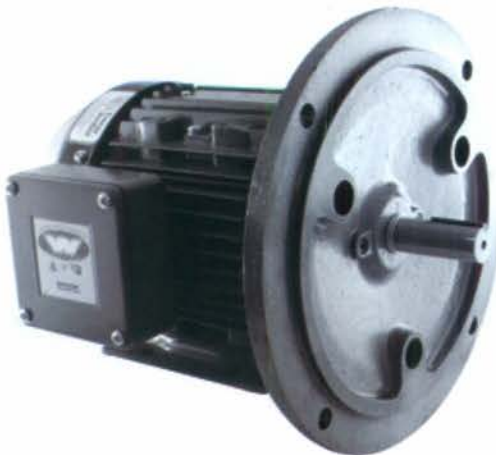

Lightweight High Performance  
Cast Aluminum Frames. Features  
Include:

- NEMA MG1-Part 31 inverter duty 15:1 constant torque, 20:1 variable torque
- 1.25 service factor at 60Hz, 1.0 service factor at 50Hz
- Class F insulation with class B temperature rise
- Removable/ repositionable feet for easy conversion to F1, F2, F3 (F0), or round body configuration
- IP55 degree of protection for washdown duty applications
- Full contact shaft seals inside both brackets for increased protection against contaminants
- Dual rated 60/50Hz at same HP
- Cast aluminum conduit box with drilled and tapped entry is rotatable in 90 degree increments
- CSA approved for Class I; Division 2; Groups A, B, C & D, Zone 2; Groups IIA & IIB T3 on sine wave power
- Internal tropicproof
- 3 year warranty

**Notes:**

RF - Removable Feet  
TM - Thermistors



## W Series NEMA 143T-286T, 3 Phase - TEFC Foot Mounted - Cast Aluminum

HP	RPM	Frame	Voltage	P/N	FL Eff.	C Dim. (IN)	S.F. 60 Hz	FL Amps	LBS	Notes
0.75	1200	143/5T	230/460 V	BA6N.75-4	81.7	14.18	1.25	1.70	28	RF
	1200	143/5T	575 V	BA6N.75-5	81.7	14.18	1.25	1.36	28	RF
1	1800	143/5T	208/416 V	BA4N001-3	85.5	14.18	1.25	1.55	40	RF
	1800	143/5T	230/460 V	BA4N001-4	85.5	14.18	1.25	1.40	40	RF
	1800	143/5T	575 V	BA4N001-5	85.5	14.18	1.25	1.12	40	RF
	1200	145T	208/416 V	PA6N001-3	85.5	13.70	1.25	1.66	42	RF
	1200	145T	230/460 V	PA6N001-4	85.5	13.70	1.25	1.50	42	RF
	1200	145T	575 V	PA6N001-5	85.5	13.70	1.25	1.20	42	RF
1.5	3600	143/5T	208/416 V	BA2N1.5-3	84	14.18	1.25	2.10	40	RF
	3600	143/5T	230/460 V	BA2N1.5-4	84	14.18	1.25	1.90	40	RF
	3600	143/5T	575 V	BA2N1.5-5	84	14.18	1.25	1.52	40	RF
	1800	143/5T	208/416 V	BA4N1.5-3	86.5	14.18	1.25	2.32	42	RF
	1800	143/5T	230/460 V	BA4N1.5-4	86.5	14.18	1.25	2.10	42	RF
	1800	143/5T	575 V	BA4N1.5-5	86.5	14.18	1.25	1.68	42	RF
	1200	182T	208/416 V	PA6N1.5-3	87.5	15.10	1.25	2.43	90	RF
	1200	182T	230/460 V	PA6N1.5-4	87.5	15.10	1.25	2.20	90	RF
	1200	182T	575 V	PA6N1.5-5	87.5	15.10	1.25	1.80	90	RF
2	3600	143/5T	208/416 V	BA2N002-3	85.5	14.18	1.25	2.88	42	RF
	3600	143/5T	230/460 V	BA2N002-4	85.5	14.18	1.25	2.60	42	RF
	3600	143/5T	575 V	BA2N002-5	85.5	14.18	1.25	2.08	42	RF
	1800	143/5T	208/416 V	BA4N002-3	86.5	14.18	1.25	3.21	42	RF
	1800	143/5T	230/460 V	BA4N002-4	86.5	14.18	1.25	2.90	42	RF
	1800	143/5T	575 V	BA4N002-5	86.5	14.18	1.25	2.32	42	RF
	1200	184T	208/416 V	PA6N002-3	88.5	16.10	1.25	3.32	102	RF
	1200	184T	230/460 V	PA6N002-4	88.5	16.10	1.25	3.00	102	RF
	1200	184T	575 V	PA6N002-5	88.5	16.10	1.25	2.40	102	RF
3	3600	182/4T	208/416 V	BA2N003-3	86.5	15.43	1.25	3.87	90	RF
	3600	182/4T	230/460 V	BA2N003-4	86.5	15.43	1.25	3.50	90	RF
	3600	182/4T	575 V	BA2N003-5	86.5	15.43	1.25	2.80	90	RF
	1800	182/4T	208/416 V	BA4N003-3	89.5	15.43	1.25	4.31	90	RF
	1800	182/4T	230/460 V	BA4N003-4	89.5	15.43	1.25	3.90	90	RF
	1800	182/4T	575 V	BA4N003-5	89.5	15.43	1.25	3.12	90	RF
	1200	213T	208/416 V	PA6N003-3	89.5	18.30	1.25	4.64	130	RF
	1200	213T	230/460 V	PA6N003-4	89.5	18.30	1.25	4.20	130	RF
	1200	213T	575 V	PA6N003-5	89.5	18.30	1.25	3.40	130	RF
5	3600	182/4T	208/416 V	BA2N005-3	88.5	16.27	1.25	6.41	102	RF
	3600	182/4T	230/460 V	BA2N005-4	88.5	16.27	1.25	5.80	102	RF
	3600	182/4T	575 V	BA2N005-5	88.5	16.27	1.25	4.64	102	RF
	1800	182/4T	208/416 V	BA4N005-3	89.5	16.27	1.25	7.19	102	RF
	1800	182/4T	230/460 V	BA4N005-4	89.5	16.27	1.25	6.50	102	RF
	1800	182/4T	575 V	BA4N005-5	89.5	16.27	1.25	5.20	102	RF
	1200	215T	208/416 V	PA6N005-3	89.5	19.80	1.25	7.85	150	RF
	1200	215T	230/460 V	PA6N005-4	89.5	19.80	1.25	7.10	150	RF
	1200	215T	575 V	PA6N005-5	89.5	19.80	1.25	5.70	150	RF
7.5	3600	213/5T	208/416 V	BA2N7.5-3	89.5	19.30	1.25	9.29	130	RF
	3600	213/5T	230/460 V	BA2N7.5-4	89.5	19.30	1.25	8.40	130	RF
	3600	213/5T	575 V	BA2N7.5-5	89.5	19.30	1.25	6.72	130	RF
	1800	213/5T	208/416 V	BA4N7.5-3	91.7	19.30	1.25	10.84	130	RF
	1800	213/5T	230/460 V	BA4N7.5-4	91.7	19.30	1.25	9.80	130	RF
	1800	213/5T	575 V	BA4N7.5-5	91.7	19.30	1.25	7.84	130	RF
	1200	254/6T	208/416 V	BA6N7.5-3	91	23.44	1.25	10.73	252	RF, TM
	1200	254/6T	230/460 V	BA6N7.5-4	91	23.44	1.25	9.70	252	RF, TM
	1200	254/6T	575 V	BA6N7.5-5	91	23.44	1.25	7.76	252	RF, TM

Discount Category **16**



## W Series NEMA 143T-286T, 3 Phase - TEFC Foot Mounted - Cast Aluminum

HP	RPM	Frame	Voltage	P/N	FL Eff.	C Dim. (IN)	S.F. 60 Hz	FL Amps	LBS	Notes
10	3600	213/5T	208/416 V	BA2N010-3	90.2	19.30	1.25	12.83	150	RF
	3600	213/5T	230/460 V	BA2N010-4	90.2	19.30	1.25	11.60	150	RF
	3600	213/5T	575 V	BA2N010-5	90.2	19.30	1.25	9.30	150	RF
	1800	213/5T	208/416 V	BA4N010-3	91.7	19.30	1.25	14.60	150	RF
	1800	213/5T	230/460 V	BA4N010-4	91.7	19.30	1.25	13.20	150	RF
	1800	213/5T	575 V	BA4N010-5	91.7	19.30	1.25	10.50	150	RF
	1200	254/6T	208/416 V	BA6N010-3	91	23.44	1.25	15.80	280	RF, TM
	1200	254/6T	230/460 V	BA6N010-4	91	23.44	1.25	14.29	280	RF, TM
	1200	254/6T	575 V	BA6N010-5	91	23.44	1.25	11.43	280	RF, TM
15	3600	254/6T	208/416 V	BA2N015-3	91	23.44	1.25	18.80	252	RF, TM
	3600	254/6T	230/460 V	BA2N015-4	91	23.44	1.25	17.00	252	RF, TM
	3600	254/6T	575 V	BA2N015-5	91	23.44	1.25	13.60	252	RF, TM
	1800	254/6T	208/416 V	BA4N015-3	92.4	23.44	1.25	19.68	280	RF, TM
	1800	254/6T	230/460 V	BA4N015-4	92.4	23.44	1.25	17.80	280	RF, TM
	1800	254/6T	575 V	BA4N015-5	92.4	23.44	1.25	14.20	280	RF, TM
	1200	284/6T	208/416 V	BA6N015-3	91.7	26.34	1.25	23.52	368	RF, TM
	1200	284/6T	230/460 V	BA6N015-4	91.7	26.34	1.25	21.27	368	RF, TM
	1200	284/6T	575 V	BA6N015-5	91.7	26.34	1.25	17.02	368	RF, TM
20	3600	254/6T	208/416 V	BA2N020-3	91	23.44	1.25	24.55	280	RF, TM
	3600	254/6T	230/460 V	BA2N020-4	91	23.44	1.25	22.20	280	RF, TM
	3600	254/6T	575 V	BA2N020-5	91	23.44	1.25	17.80	280	RF, TM
	1800	254/6T	208/416 V	BA4N020-3	93	23.44	1.25	25.76	280	RF, TM
	1800	254/6T	230/460 V	BA4N020-4	93	23.44	1.25	23.30	280	RF, TM
	1800	254/6T	575 V	BA4N020-5	93	23.44	1.25	18.60	280	RF, TM
	1200	284/6T	208/416 V	BA6N020-3	91.7	26.34	1.25	30.52	368	RF, TM
	1200	284/6T	230/460 V	BA6N020-4	91.7	26.34	1.25	27.60	368	RF, TM
	1200	284/6T	575 V	BA6N020-5	91.7	26.34	1.25	22.08	368	RF, TM
25	3600	284/6TS	208/416 V	BA2N025-3	91.7	24.97	1.25	30.08	315	RF, TM
	3600	284/6TS	230/460 V	BA2N025-4	91.7	24.97	1.25	27.20	315	RF, TM
	3600	284/6TS	575 V	BA2N025-5	91.7	24.97	1.25	21.80	315	RF, TM
	1800	284/6T	208/416 V	BA4N025-3	93.6	26.34	1.25	30.85	315	RF, TM
	1800	284/6T	230/460 V	BA4N025-4	93.6	26.34	1.25	27.90	315	RF, TM
	1800	284/6T	575 V	BA4N025-5	93.6	26.34	1.25	22.30	315	RF, TM
30	3600	284/6TS	208/416 V	BA2N030-3	91.7	24.97	1.25	35.83	368	RF, TM
	3600	284/6TS	230/460 V	BA2N030-4	91.7	24.97	1.25	32.40	368	RF, TM
	3600	284/6TS	575 V	BA2N030-5	91.7	24.97	1.25	25.90	368	RF, TM
	1800	284/6T	208/416 V	BA4N030-3	93.6	26.34	1.25	37.49	368	RF, TM
	1800	284/6T	230/460 V	BA4N030-4	93.6	26.34	1.25	33.90	368	RF, TM
	1800	284/6T	575 V	BA4N030-5	93.6	26.34	1.25	27.10	368	RF, TM

Discount Category **16**



## W Series NEMA 143TC-286TC, 3 Phase - TEFC C-Face With Removable Feet - Cast Aluminum

HP	RPM	Frame	Voltage	P/N	FL Eff.	C Dim. (IN)	S.F. 60 Hz	FL Amps	LBS	Notes
0.75	1200	143/5TC	230/460 V	BA6N.75-4C	81.7	14.18	1.25	1.70	38	RF
	1200	143/5TC	575 V	BA6N.75-5C	81.7	14.18	1.25	1.36	38	RF
1	1800	143/5TC	208/416 V	BA4N001-3C	85.5	14.18	1.25	1.55	50	RF
	1800	143/5TC	230/460 V	BA4N001-4C	85.5	14.18	1.25	1.40	50	RF
	1800	143/5TC	575 V	BA4N001-5C	85.5	14.18	1.25	1.12	50	RF
	1200	145TC	208/416 V	PA6N001-3C	85.5	13.70	1.25	1.66	52	RF
	1200	145TC	230/460 V	PA6N001-4C	85.5	13.70	1.25	1.50	52	RF
	1200	145TC	575 V	PA6N001-5C	85.5	13.70	1.25	1.20	52	RF
1.5	3600	143/5TC	208/416 V	BA2N1.5-3C	84	14.18	1.25	2.10	50	RF
	3600	143/5TC	230/460 V	BA2N1.5-4C	84	14.18	1.25	1.90	50	RF
	3600	143/5TC	575 V	BA2N1.5-5C	84	14.18	1.25	1.52	50	RF
	1800	143/5TC	208/416 V	BA4N1.5-3C	86.5	14.18	1.25	2.32	52	RF
	1800	143/5TC	230/460 V	BA4N1.5-4C	86.5	14.18	1.25	2.10	52	RF
	1800	143/5TC	575 V	BA4N1.5-5C	86.5	14.18	1.25	1.68	52	RF
	1200	182TC	208/416 V	PA6N1.5-3C	87.5	15.10	1.25	2.43	100	RF
	1200	182TC	230/460 V	PA6N1.5-4C	87.5	15.10	1.25	2.20	100	RF
2	1200	182TC	575 V	PA6N1.5-5C	87.5	15.10	1.25	1.80	100	RF
	3600	143/5TC	208/416 V	BA2N002-3C	85.5	14.18	1.25	2.88	52	RF
	3600	143/5TC	230/460 V	BA2N002-4C	85.5	14.18	1.25	2.60	52	RF
	3600	143/5TC	575 V	BA2N002-5C	85.5	14.18	1.25	2.08	52	RF
	1800	143/5TC	208/416 V	BA4N002-3C	86.5	14.18	1.25	3.21	52	RF
	1800	143/5TC	230/460 V	BA4N002-4C	86.5	14.18	1.25	2.90	52	RF
	1800	143/5TC	575 V	BA4N002-5C	86.5	14.18	1.25	2.32	52	RF
	1200	184TC	208/416 V	PA6N002-3C	88.5	16.10	1.25	3.32	112	RF
3	1200	184TC	230/460 V	PA6N002-4C	88.5	16.10	1.25	3.00	112	RF
	1200	184TC	575 V	PA6N002-5C	88.5	16.10	1.25	2.40	112	RF
	3600	182/4TC	208/416 V	BA2N003-3C	86.5	15.43	1.25	3.87	100	RF
	3600	182/4TC	230/460 V	BA2N003-4C	86.5	15.43	1.25	3.50	100	RF
	3600	182/4TC	575 V	BA2N003-5C	86.5	15.43	1.25	2.80	100	RF
	1800	182/4TC	208/416 V	BA4N003-3C	89.5	15.43	1.25	4.31	100	RF
	1800	182/4TC	230/460 V	BA4N003-4C	89.5	15.43	1.25	3.90	100	RF
	1800	182/4TC	575 V	BA4N003-5C	89.5	15.43	1.25	3.12	100	RF
5	1200	213TC	208/416 V	PA6N003-3C	89.5	18.30	1.25	4.64	132	RF
	1200	213TC	230/460 V	PA6N003-4C	89.5	18.30	1.25	4.20	132	RF
	1200	213TC	575 V	PA6N003-5C	89.5	18.30	1.25	3.40	132	RF
	3600	182/4TC	208/416 V	BA2N005-3C	88.5	16.27	1.25	6.41	112	RF
	3600	182/4TC	230/460 V	BA2N005-4C	88.5	16.27	1.25	5.80	112	RF
	3600	182/4TC	575 V	BA2N005-5C	88.5	16.27	1.25	4.64	112	RF
	1800	182/4TC	208/416 V	BA4N005-3C	89.5	16.27	1.25	7.19	112	RF
	1800	182/4TC	230/460 V	BA4N005-4C	89.5	16.27	1.25	6.50	112	RF
7.5	1800	182/4TC	575 V	BA4N005-5C	89.5	16.27	1.25	5.20	112	RF
	1200	215TC	208/416 V	PA6N005-3C	89.5	19.80	1.25	7.85	162	RF
	1200	215TC	230/460 V	PA6N005-4C	89.5	19.80	1.25	7.10	162	RF
	1200	215TC	575 V	PA6N005-5C	89.5	19.80	1.25	5.70	162	RF
	3600	213/5TC	208/416 V	BA2N7.5-3C	89.5	19.30	1.25	9.29	142	RF
	3600	213/5TC	230/460 V	BA2N7.5-4C	89.5	19.30	1.25	8.40	142	RF
	3600	213/5TC	575 V	BA2N7.5-5C	89.5	19.30	1.25	6.72	142	RF
	1800	213/5TC	208/416 V	BA4N7.5-3C	91.7	19.30	1.25	10.84	142	RF
	1800	213/5TC	230/460 V	BA4N7.5-4C	91.7	19.30	1.25	9.80	142	RF
	1800	213/5TC	575 V	BA4N7.5-5C	91.7	19.30	1.25	7.84	142	RF
7.5	1200	254/6TC	208/416 V	BA6N7.5-3C	91	23.44	1.25	10.73	264	RF, TM
	1200	254/6TC	230/460 V	BA6N7.5-4C	91	23.44	1.25	9.70	264	RF, TM
	1200	254/6TC	575 V	BA6N7.5-5C	91	23.44	1.25	7.76	264	RF, TM

Discount Category **16**



**W Series NEMA 143TC-286TC, 3 Phase - TEFC  
C-Face With Removable Feet - Cast Aluminum**

HP	RPM	Frame	Voltage	P/N	FL Eff.	C Dim. (IN)	S.F. 60 Hz	FL Amps	LBS	Notes
10	3600	213/5TC	208/416 V	BA2N010-3C	90.2	19.30	1.25	12.83	162	RF
	3600	213/5TC	230/460 V	BA2N010-4C	90.2	19.30	1.25	11.60	162	RF
	3600	213/5TC	575 V	BA2N010-5C	90.2	19.30	1.25	9.30	162	RF
	1800	213/5TC	208/416 V	BA4N010-3C	91.7	19.30	1.25	14.60	162	RF
	1800	213/5TC	230/460 V	BA4N010-4C	91.7	19.30	1.25	13.20	162	RF
	1800	213/5TC	575 V	BA4N010-5C	91.7	19.30	1.25	10.50	162	RF
	1200	254/6TC	208/416 V	BA6N010-3C	91	23.44	1.25	15.80	292	RF, TM
	1200	254/6TC	230/460 V	BA6N010-4C	91	23.44	1.25	14.29	292	RF, TM
	1200	254/6TC	575 V	BA6N010-5C	91	23.44	1.25	11.43	292	RF, TM
15	3600	254/6TC	208/416 V	BA2N015-3C	91	23.44	1.25	18.80	264	RF, TM
	3600	254/6TC	230/460 V	BA2N015-4C	91	23.44	1.25	17.00	264	RF, TM
	3600	254/6TC	575 V	BA2N015-5C	91	23.44	1.25	13.60	264	RF, TM
	1800	254/6TC	208/416 V	BA4N015-3C	92.4	23.44	1.25	19.68	292	RF, TM
	1800	254/6TC	230/460 V	BA4N015-4C	92.4	23.44	1.25	17.80	292	RF, TM
	1800	254/6TC	575 V	BA4N015-5C	92.4	23.44	1.25	14.20	292	RF, TM
	1200	284/6TC	208/416 V	BA6N015-3C	91.7	26.34	1.25	23.52	380	RF, TM
	1200	284/6TC	230/460 V	BA6N015-4C	91.7	26.34	1.25	21.27	380	RF, TM
	1200	284/6TC	575 V	BA6N015-5C	91.7	26.34	1.25	17.02	380	RF, TM
20	3600	254/6TC	208/416 V	BA2N020-3C	91	23.44	1.25	24.55	292	RF, TM
	3600	254/6TC	230/460 V	BA2N020-4C	91	23.44	1.25	22.20	292	RF, TM
	3600	254/6TC	575 V	BA2N020-5C	91	23.44	1.25	17.80	292	RF, TM
	1800	254/6TC	208/416 V	BA4N020-3C	93	23.44	1.25	25.76	292	RF, TM
	1800	254/6TC	230/460 V	BA4N020-4C	93	23.44	1.25	23.30	292	RF, TM
	1800	254/6TC	575 V	BA4N020-5C	93	23.44	1.25	18.60	292	RF, TM
	1200	284/6TC	208/416 V	BA6N020-3C	91.7	26.34	1.25	30.52	380	RF, TM
	1200	284/6TC	230/460 V	BA6N020-4C	91.7	26.34	1.25	27.60	380	RF, TM
	1200	284/6TC	575 V	BA6N020-5C	91.7	26.34	1.25	22.08	380	RF, TM
25	3600	284/6TSC	208/416 V	BA2N025-3C	91.7	24.97	1.25	30.08	329	RF, TM
	3600	284/6TSC	230/460 V	BA2N025-4C	91.7	24.97	1.25	27.20	329	RF, TM
	3600	284/6TSC	575 V	BA2N025-5C	91.7	24.97	1.25	21.80	329	RF, TM
	1800	284/6TC	208/416 V	BA4N025-3C	93.6	26.34	1.25	30.85	329	RF, TM
	1800	284/6TC	230/460 V	BA4N025-4C	93.6	26.34	1.25	27.90	329	RF, TM
	1800	284/6TC	575 V	BA4N025-5C	93.6	26.34	1.25	22.30	329	RF, TM
30	3600	284/6TSC	208/416 V	BA2N030-3C	91.7	24.97	1.25	35.83	380	RF, TM
	3600	284/6TSC	230/460 V	BA2N030-4C	91.7	24.97	1.25	32.40	380	RF, TM
	3600	284/6TSC	575 V	BA2N030-5C	91.7	24.97	1.25	25.90	380	RF, TM
	1800	284/6TC	208/416 V	BA4N030-3C	93.6	26.34	1.25	37.49	380	RF, TM
	1800	284/6TC	230/460 V	BA4N030-4C	93.6	26.34	1.25	33.90	380	RF, TM
	1800	284/6TC	575 V	BA4N030-5C	93.6	26.34	1.25	27.10	380	RF, TM

**Discount Category 16**



**W Series IEC 63-180L, 3 Phase - TEFC  
Cast Aluminum Construction**



Lightweight High Performance Cast Aluminum Frames. Features Include:

- NEMA MG1-Part 31 inverter duty 15:1 constant torque, 20:1 variable torque
- 1.25 service factor at 60Hz, 1.0 service factor at 50Hz
- Class F insulation with class B temperature rise
- IP55 degree of protection for washdown duty enclosure
- Full contact shaft seals inside both brackets for increased protection against contaminants
- Removable/ repositionable feet for easy conversion to terminal box on top, left, right, or round body configuration
- IEC style terminal blocks included inside junction box
- Meets IEC 60034 electrical performance and IEC 60072 dimensional standards
- Dual rated 60/50Hz at same HP
- Cast aluminum conduit box with drilled and tapped entry is rotatable in 90 degree increments
- CSA approved for Class I; Division 2; Groups A, B, C & D, Zone 2; Groups IIA & IIB T3 on sine wave power
- Internal tropicproof
- Thermistors included in motors 160M and above. 1 per phase
- 3 year warranty

**Notes:**

- RF - Removable Feet
- TM - Thermistors
- EU - Euronorm Dimensions



## W Series IEC 63-180L, 3 Phase - TEFC B3 (Foot Mount) - Cast Aluminum

HP	Kw	RPM	Frame	Voltage	P/N	FL Eff.	L Dim. (mm)	S.F. 60 Hz	FL Amps	LBS	Notes
0.25	0.18	3600	63	230/460 V	BA2M.25-4	64	207	1.25	0.60	10	RF, EU
		3600	63	575 V	BA2M.25-5	64	207	1.25	0.40	10	RF, EU
		1800	63	230/460 V	BA4M.25-4	58	207	1.25	0.80	10	RF, EU
		1800	63	575 V	BA4M.25-5	58	207	1.25	0.60	10	RF, EU
		1200	71	230/460 V	BA6M.25-4	61	238	1.25	0.80	16	RF, EU
		1200	71	575 V	BA6M.25-5	61	238	1.25	0.60	16	RF, EU
		900	80	230/460 V	BA8M.25-4	57	278	1.25	0.87	22	RF, EU
		900	80	575 V	BA8M.25-5	57	278	1.25	0.70	22	RF, EU
0.33	0.25	3600	63	230/460 V	BA2M.33-4	65	207	1.25	0.60	10	RF, EU
		3600	63	575 V	BA2M.33-5	65	207	1.25	0.50	10	RF, EU
		1800	71	230/460 V	BA4M.33-4	70	238	1.25	0.70	16	RF, EU
		1800	71	575 V	BA4M.33-5	70	238	1.25	0.60	16	RF, EU
		1200	71	230/460 V	BA6M.33-4	68	238	1.25	0.70	16	RF, EU
		1200	71	575 V	BA6M.33-5	68	238	1.25	0.60	16	RF, EU
		900	80	230/460 V	BA8M.33-4	62	278	1.25	0.75	22	RF, EU
		900	80	575 V	BA8M.33-5	62	278	1.25	0.60	22	RF, EU
0.50	0.37	3600	71	230/460 V	BA2M.50-4	71	238	1.25	0.90	16	RF, EU
		3600	71	575 V	BA2M.50-5	71	238	1.25	0.70	16	RF, EU
		1800	71	230/460 V	BA4M.50-4	73	238	1.25	1.00	16	RF, EU
		1800	71	575 V	BA4M.50-5	73	238	1.25	0.80	16	RF, EU
		1200	80	230/460 V	BA6M.50-4	65	278	1.25	1.10	22	RF, EU
		1200	80	575 V	BA6M.50-5	65	278	1.25	0.90	22	RF, EU
		900	90S/L	230/460 V	BA8M.50-4	62	364	1.25	1.38	28	RF, EU
		900	90S/L	575 V	BA8M.50-5	62	364	1.25	1.10	28	RF, EU
0.75	0.55	3600	71	230/460 V	BA2M.75-4	74	238	1.25	1.20	18	RF, EU
		3600	71	575 V	BA2M.75-5	74	238	1.25	1.00	18	RF, EU
		1800	80	230/460 V	BA4M.75-4	77	278	1.25	1.40	24	RF, EU
		1800	80	575 V	BA4M.75-5	77	278	1.25	1.10	24	RF, EU
		1200	80	230/460 V	BA6M.75-4	71	278	1.25	1.50	24	RF, EU
		1200	80	575 V	BA6M.75-5	71	278	1.25	1.20	24	RF, EU
		900	90S/L	230/460 V	BA8M.75-4	66	364	1.25	1.82	28	RF, EU
		900	90S/L	575 V	BA8M.75-5	66	364	1.25	1.46	28	RF, EU
1	0.75	3600	80	230/460 V	BA2M001-4	78	278	1.25	1.60	28	RF, EU
		3600	80	575 V	BA2M001-5	78	278	1.25	1.30	28	RF, EU
		1800	80	230/460 V	BA4M001-4	77	278	1.25	1.80	28	RF, EU
		1800	80	575 V	BA4M001-5	77	278	1.25	1.40	28	RF, EU
		1200	90S	230/460 V	PA6M001-2	80	325	1.25	1.90	28	RF, EU
		1200	90S	575 V	PA6M001-5	80	325	1.25	1.50	28	RF, EU
1.5	1.1	3600	80	230/460 V	BA2M1.5-4	79	278	1.25	2.30	28	RF, EU
		3600	80	575 V	BA2M1.5-5	79	278	1.25	1.80	28	RF, EU
		1800	90S/L	230/460 V	BA4M1.5-4	86.5	364	1.25	2.10	42	RF, EU
		1800	90S/L	575 V	BA4M1.5-5	86.5	364	1.25	1.60	42	RF, EU
2	1.5	3600	90S/L	230/460 V	BA2M002-4	85.5	364	1.25	2.60	42	RF, EU
		3600	90S/L	575 V	BA2M002-5	85.5	364	1.25	2.00	42	RF, EU
		1800	90S/L	230/460 V	BA4M002-4	86.5	364	1.25	2.90	46	RF, EU
		1800	90S/L	575 V	BA4M002-5	86.5	364	1.25	2.30	46	RF, EU
		1200	100L	230/460 V	PA6M002-2	88.5	388	1.25	3.00	85	RF, EU
		1200	100L	575 V	PA6M002-5	88.5	388	1.25	2.40	85	RF, EU
3	2.2	3600	90S/L	230/460 V	BA2M003-4	86.5	364	1.25	3.50	42	RF, EU
		3600	90S/L	575 V	BA2M003-5	86.5	364	1.25	2.80	42	RF, EU
		1800	100L	230/460 V	BA4M003-4	89.5	409	1.25	3.90	85	RF, EU
		1800	100L	575 V	BA4M003-5	89.5	409	1.25	3.10	85	RF, EU
		1200	112M	230/460 V	PA6M003-2	89.5	405	1.25	4.20	150	RF, EU
		1200	112M	575 V	PA6M003-5	89.5	405	1.25	3.40	150	RF, EU



**W Series IEC 63-180L, 3 Phase - TEFC  
B3 (Foot Mount) - Cast Aluminum**

HP	Kw	RPM	Frame	Voltage	P/N	FL Eff.	L Dim. (mm)	S.F. 60 Hz	FL Amps	LBS	Notes
4	3	3600	100L	230/460 V	BA2M004-4	88.5	409	1.25	4.90	85	RF, EU
		3600	100L	575 V	BA2M004-5	88.5	409	1.25	3.90	85	RF, EU
		1800	100L	230/460 V	BA4M004-4	89.5	409	1.25	5.50	85	RF, EU
		1800	100L	575 V	BA4M004-5	89.5	409	1.25	4.40	85	RF, EU
		1200	132S	230/460 V	PA6M004-2	89.5	459	1.25	6.10	150	RF, EU
		1200	132S	575 V	PA6M004-5	89.5	459	1.25	4.80	150	RF, EU
5.5	4	3600	112M	230/460 V	BA2M5.5-4	88.5	402	1.25	5.90	100	RF, EU
		3600	112M	575 V	BA2M5.5-5	88.5	402	1.25	4.70	100	RF, EU
		1800	112M	230/460 V	BA4M5.5-4	89.5	402	1.25	6.20	100	RF, EU
		1800	112M	575 V	BA4M5.5-5	89.5	402	1.25	5.00	100	RF, EU
		1200	132M	230/460 V	PA6M5.5-2	89.5	497	1.25	7.10	150	RF, EU
		1200	132M	575 V	PA6M5.5-5	89.5	497	1.25	5.70	150	RF, EU
7.5	5.5	3600	132S/M	230/460 V	BA2M7.5-4	89.5	484	1.25	8.40	130	RF, EU
		3600	132S/M	575 V	BA2M7.5-5	89.5	484	1.25	6.70	130	RF, EU
		1800	132S/M	230/460 V	BA4M7.5-4	91.7	484	1.25	9.80	130	RF, EU
		1800	132S/M	575 V	BA4M7.5-5	91.7	484	1.25	7.80	130	RF, EU
		1200	132S/M	230/460 V	BA6M7.5-4	91	484	1.25	10.60	150	RF, EU
		1200	132S/M	575 V	BA6M7.5-5	91	484	1.25	8.50	150	RF, EU
10	7.5	3600	132S/M	230/460 V	BA2M010-4	90.2	484	1.25	11.60	130	RF, EU
		3600	132S/M	575 V	BA2M010-5	90.2	484	1.25	9.20	130	RF, EU
		1800	132S/M	230/460 V	BA4M010-4	91.7	484	1.25	13.20	150	RF, EU
		1800	132S/M	575 V	BA4M010-5	91.7	484	1.25	10.50	150	RF, EU
		1200	160M/L	230/460 V	BA6M010-4	91	604	1.25	14.10	252	RF, EU, TM
		1200	160M/L	575 V	BA6M010-5	91	604	1.25	17.70	252	RF, EU, TM
15	11	3600	160M/L	230/460 V	BA2M015-4	91	604	1.25	17.00	252	RF, EU, TM
		3600	160M/L	575 V	BA2M015-5	91	604	1.25	13.60	252	RF, EU, TM
		1800	160M/L	230/460 V	BA4M015-4	92.4	604	1.25	17.80	252	RF, EU, TM
		1800	160M/L	575 V	BA4M015-5	92.4	604	1.25	14.20	252	RF, EU, TM
		1200	160M/L	230/460 V	BA6M015-4	91.7	604	1.25	19.30	280	RF, EU, TM
		1200	160M/L	575 V	BA6M015-5	91.7	604	1.25	15.40	280	RF, EU, TM
20	15	3600	160M/L	230/460 V	BA2M020-4	91	604	1.25	22.20	252	RF, EU, TM
		3600	160M/L	575 V	BA2M020-5	91	604	1.25	17.70	252	RF, EU, TM
		1800	160M/L	230/460 V	BA4M020-4	93	604	1.25	23.30	280	RF, EU, TM
		1800	160M/L	575 V	BA4M020-5	93	604	1.25	18.60	280	RF, EU, TM
		1200	180M/L	230/460 V	BA6M020-4	91.7	663	1.25	25.70	368	RF, EU, TM
		1200	180M/L	575 V	BA6M020-5	91.7	663	1.25	20.60	368	RF, EU, TM
25	18.5	3600	160M/L	230/460 V	BA2M025-4	91.7	604	1.25	27.20	280	RF, EU, TM
		3600	160M/L	575 V	BA2M025-5	91.7	604	1.25	21.76	280	RF, EU, TM
		1800	180M/L	230/460 V	BA4M025-4	93.6	663	1.25	27.90	315	RF, EU, TM
		1800	180M/L	575 V	BA4M025-5	93.6	663	1.25	22.32	315	RF, EU, TM
30	22	3600	180M/L	230/460 V	BA2M030-4	91.7	663	1.25	32.40	315	RF, EU, TM
		3600	180M/L	575 V	BA2M030-5	91.7	663	1.25	25.92	315	RF, EU, TM
		1800	180M/L	230/460 V	BA4M030-4	93.6	663	1.25	33.90	368	RF, EU, TM
		1800	180M/L	575 V	BA4M030-5	93.6	663	1.25	27.12	368	RF, EU, TM

Discount Category **17**



## W Series IEC 63-180L, 3 Phase - TEFC B14 (C-Face With B3 Removable Feet) - Cast Aluminum

HP	Kw	RPM	Frame	Voltage	P/N	FL Eff.	L Dim. (mm)	S.F. 60 Hz	FL Amps	LBS	Notes
0.25	0.18	3600	63	230/460 V	BA2M.25-4C	64	207	1.25	0.60	14	RF, EU
		3600	63	575 V	BA2M.25-5C	64	207	1.25	0.40	14	RF, EU
		1800	63	230/460 V	BA4M.25-4C	58	207	1.25	0.80	14	RF, EU
		1800	63	575 V	BA4M.25-5C	58	207	1.25	0.60	14	RF, EU
		1200	71	230/460 V	BA6M.25-4C	61	238	1.25	0.80	20	RF, EU
		1200	71	575 V	BA6M.25-5C	61	238	1.25	0.60	20	RF, EU
		900	80	230/460 V	BA8M.25-4C	57	278	1.25	0.87	26	RF, EU
		900	80	575 V	BA8M.25-5C	57	278	1.25	0.70	26	RF, EU
0.33	0.25	3600	63	230/460 V	BA2M.33-4C	65	207	1.25	0.60	14	RF, EU
		3600	63	575 V	BA2M.33-5C	65	207	1.25	0.50	14	RF, EU
		1800	71	230/460 V	BA4M.33-4C	70	238	1.25	0.70	20	RF, EU
		1800	71	575 V	BA4M.33-5C	70	238	1.25	0.60	20	RF, EU
		1200	71	230/460 V	BA6M.33-4C	68	238	1.25	0.70	20	RF, EU
		1200	71	575 V	BA6M.33-5C	68	238	1.25	0.60	20	RF, EU
		900	80	230/460 V	BA8M.33-4C	62	278	1.25	0.75	26	RF, EU
		900	80	575 V	BA8M.33-5C	62	278	1.25	0.60	26	RF, EU
0.50	0.37	3600	71	230/460 V	BA2M.50-4C	71	238	1.25	0.90	20	RF, EU
		3600	71	575 V	BA2M.50-5C	71	238	1.25	0.70	20	RF, EU
		1800	71	230/460 V	BA4M.50-4C	73	238	1.25	1.00	20	RF, EU
		1800	71	575 V	BA4M.50-5C	73	238	1.25	0.80	20	RF, EU
		1200	80	230/460 V	BA6M.50-4C	65	278	1.25	1.10	26	RF, EU
		1200	80	575 V	BA6M.50-5C	65	278	1.25	0.90	26	RF, EU
		900	90S/L	230/460 V	BA8M.50-4C	62	364	1.25	1.38	32	RF, EU
		900	90S/L	575 V	BA8M.50-5C	62	364	1.25	1.10	32	RF, EU
0.75	0.55	3600	71	230/460 V	BA2M.75-4C	74	238	1.25	1.20	20	RF, EU
		3600	71	575 V	BA2M.75-5C	74	238	1.25	1.00	20	RF, EU
		1800	80	230/460 V	BA4M.75-4C	77	278	1.25	1.40	28	RF, EU
		1800	80	575 V	BA4M.75-5C	77	278	1.25	1.10	28	RF, EU
		1200	80	230/460 V	BA6M.75-4C	71	278	1.25	1.50	28	RF, EU
		1200	80	575 V	BA6M.75-5C	71	278	1.25	1.20	28	RF, EU
		900	90S/L	230/460 V	BA8M.75-4C	66	364	1.25	1.82	32	RF, EU
		900	90S/L	575 V	BA8M.75-5C	66	364	1.25	1.46	32	RF, EU
1	0.75	3600	80	230/460 V	BA2M001-4C	78	278	1.25	1.60	32	RF, EU
		3600	80	575 V	BA2M001-5C	78	278	1.25	1.30	32	RF, EU
		1800	80	230/460 V	BA4M001-4C	77	278	1.25	1.80	32	RF, EU
		1800	80	575 V	BA4M001-5C	77	278	1.25	1.40	32	RF, EU
		1200	90S	230/460 V	PA6M001-2C	80	325	1.25	1.90	32	RF, EU
		1200	90S	575 V	PA6M001-5C	80	325	1.25	1.50	32	RF, EU
1.5	1.1	3600	80	230/460 V	BA2M1.5-4C	79	278	1.25	2.30	32	RF, EU
		3600	80	575 V	BA2M1.5-5C	79	278	1.25	1.80	32	RF, EU
		1800	90S/L	230/460 V	BA4M1.5-4C	86.5	364	1.25	2.10	46	RF, EU
		1800	90S/L	575 V	BA4M1.5-5C	86.5	364	1.25	1.60	46	RF, EU
2	1.5	3600	90S/L	230/460 V	BA2M002-4C	85.5	364	1.25	2.60	46	RF, EU
		3600	90S/L	575 V	BA2M002-5C	85.5	364	1.25	2.00	46	RF, EU
		1800	90S/L	230/460 V	BA4M002-4C	86.5	364	1.25	2.90	50	RF, EU
		1800	90S/L	575 V	BA4M002-5C	86.5	364	1.25	2.30	50	RF, EU
		1200	100L	230/460 V	PA6M002-2C	88.5	388	1.25	3.00	92	RF, EU
		1200	100L	575 V	PA6M002-5C	88.5	388	1.25	2.40	92	RF, EU
3	2.2	3600	90S/L	230/460 V	BA2M003-4C	86.5	364	1.25	3.50	46	RF, EU
		3600	90S/L	575 V	BA2M003-5C	86.5	364	1.25	2.80	46	RF, EU
		1800	100L	230/460 V	BA4M003-4C	89.5	409	1.25	3.90	92	RF, EU
		1800	100L	575 V	BA4M003-5C	89.5	409	1.25	3.10	92	RF, EU
		1200	112M	230/460 V	PA6M003-2C	89.5	405	1.25	4.20	100	RF, EU
		1200	112M	575 V	PA6M003-5C	89.5	405	1.25	3.40	100	RF, EU



**W Series IEC 63-180L, 3 Phase - TEFC  
B14 (C-Face With B3 Removable Feet) - Cast Aluminum**

HP	Kw	RPM	Frame	Voltage	P/N	FL Eff.	L Dim. (mm)	S.F. 60 Hz	FL Amps	LBS	Notes
4	3	3600	100L	230/460 V	BA2M004-4C	88.5	409	1.25	4.90	60	RF, EU
		3600	100L	575 V	BA2M004-5C	88.5	409	1.25	3.90	60	RF, EU
		1800	100L	230/460 V	BA4M004-4C	89.5	409	1.25	5.50	60	RF, EU
		1800	100L	575 V	BA4M004-5C	89.5	409	1.25	4.40	60	RF, EU
		1200	132S	230/460 V	PA6M004-2C	89.5	459	1.25	6.10	110	RF, EU
		1200	132S	575 V	PA6M004-5C	89.5	459	1.25	4.80	110	RF, EU
5.5	4	3600	112M	230/460 V	BA2M5.5-4C	88.5	402	1.25	5.90	73	RF, EU
		3600	112M	575 V	BA2M5.5-5C	88.5	402	1.25	4.70	73	RF, EU
		1800	112M	230/460 V	BA4M5.5-4C	89.5	402	1.25	6.20	73	RF, EU
		1800	112M	575 V	BA4M5.5-5C	89.5	402	1.25	5.00	73	RF, EU
		1200	132M	230/460 V	PA6M5.5-2C	89.5	497	1.25	7.10	123	RF, EU
		1200	132M	575 V	PA6M5.5-5C	89.5	497	1.25	5.70	123	RF, EU
7.5	5.5	3600	132S/M	230/460 V	BA2M7.5-4C	89.5	484	1.25	8.40	110	RF, EU
		3600	132S/M	575 V	BA2M7.5-5C	89.5	484	1.25	6.70	110	RF, EU
		1800	132S/M	230/460 V	BA4M7.5-4C	91.7	484	1.25	9.80	110	RF, EU
		1800	132S/M	575 V	BA4M7.5-5C	91.7	484	1.25	7.80	110	RF, EU
		1200	132S/M	230/460 V	BA6M7.5-4C	91	484	1.25	10.60	123	RF, EU
		1200	132S/M	575 V	BA6M7.5-5C	91	484	1.25	8.50	123	RF, EU
10	7.5	3600	132S/M	230/460 V	BA2M010-4C	90.2	484	1.25	11.60	110	RF, EU
		3600	132S/M	575 V	BA2M010-5C	90.2	484	1.25	9.20	110	RF, EU
		1800	132S/M	230/460 V	BA4M010-4C	91.7	484	1.25	13.20	123	RF, EU
		1800	132S/M	575 V	BA4M010-5C	91.7	484	1.25	10.50	123	RF, EU
		1200	160M/L	230/460 V	BA6M010-4C	91	604	1.25	14.10	291	RF, EU, TM
		1200	160M/L	575 V	BA6M010-5C	91	604	1.25	17.70	291	RF, EU, TM
15	11	3600	160M/L	230/460 V	BA2M015-4C	91	604	1.25	17.00	221	RF, EU, TM
		3600	160M/L	575 V	BA2M015-5C	91	604	1.25	13.60	221	RF, EU, TM
		1800	160M/L	230/460 V	BA4M015-4C	92.4	604	1.25	17.80	221	RF, EU, TM
		1800	160M/L	575 V	BA4M015-5C	92.4	604	1.25	14.20	221	RF, EU, TM
		1200	160M/L	230/460 V	BA6M015-4C	91.7	604	1.25	19.30	234	RF, EU, TM
		1200	160M/L	575 V	BA6M015-5C	91.7	604	1.25	15.40	234	RF, EU, TM
20	15	3600	160M/L	230/460 V	BA2M020-4C	91	604	1.25	22.20	221	RF, EU, TM
		3600	160M/L	575 V	BA2M020-5C	91	604	1.25	17.70	221	RF, EU, TM
		1800	160M/L	230/460 V	BA4M020-4C	93	604	1.25	23.30	234	RF, EU, TM
		1800	160M/L	575 V	BA4M020-5C	93	604	1.25	18.60	234	RF, EU, TM
25	18.5	3600	160M/L	230/460 V	BA2M025-4C	91.7	604	1.25	27.20	234	RF, EU, TM
		3600	160M/L	575 V	BA2M025-5C	91.7	604	1.25	21.70	234	RF, EU, TM

Discount Category **17**



**W Series IEC 63-180L, 3 Phase - TEFC  
B5 (D-Flange With B3 Removable Feet) - Cast Aluminum**

HP	Kw	RPM	Frame	Voltage	P/N	FL Eff.	L Dim. (mm)	S.F. 60 Hz	FL Amps	LBS	Notes
0.25	0.18	3600	63	230/460 V	BA2M.25-4D	64	207	1.25	0.60	14	RF, EU
		3600	63	575 V	BA2M.25-5D	64	207	1.25	0.40	14	RF, EU
		1800	63	230/460 V	BA4M.25-4D	58	207	1.25	0.80	14	RF, EU
		1800	63	575 V	BA4M.25-5D	58	207	1.25	0.60	14	RF, EU
		1200	71	230/460 V	BA6M.25-4D	61	238	1.25	0.80	20	RF, EU
		1200	71	575 V	BA6M.25-5D	61	238	1.25	0.60	20	RF, EU
		900	80	230/460 V	BA8M.25-4D	57	278	1.25	0.87	26	RF, EU
		900	80	575 V	BA8M.25-5D	57	278	1.25	0.70	26	RF, EU
0.33	0.25	3600	63	230/460 V	BA2M.33-4D	65	207	1.25	0.60	14	RF, EU
		3600	63	575 V	BA2M.33-5D	65	207	1.25	0.50	14	RF, EU
		1800	71	230/460 V	BA4M.33-4D	70	238	1.25	0.70	20	RF, EU
		1800	71	575 V	BA4M.33-5D	70	238	1.25	0.60	20	RF, EU
		1200	71	230/460 V	BA6M.33-4D	68	238	1.25	0.70	20	RF, EU
		1200	71	575 V	BA6M.33-5D	68	238	1.25	0.60	20	RF, EU
		900	80	230/460 V	BA8M.33-4D	62	278	1.25	0.75	26	RF, EU
		900	80	575 V	BA8M.33-5D	62	278	1.25	0.60	26	RF, EU
0.50	0.37	3600	71	230/460 V	BA2M.50-4D	71	238	1.25	0.90	20	RF, EU
		3600	71	575 V	BA2M.50-5D	71	238	1.25	0.70	20	RF, EU
		1800	71	230/460 V	BA4M.50-4D	73	238	1.25	1.00	20	RF, EU
		1800	71	575 V	BA4M.50-5D	73	238	1.25	0.80	20	RF, EU
		1200	80	230/460 V	BA6M.50-4D	65	278	1.25	1.10	26	RF, EU
		1200	80	575 V	BA6M.50-5D	65	278	1.25	0.90	26	RF, EU
		900	90S/L	230/460 V	BA8M.50-4D	62	364	1.25	1.38	32	RF, EU
		900	90S/L	575 V	BA8M.50-5D	62	364	1.25	1.10	32	RF, EU
0.75	0.55	3600	71	230/460 V	BA2M.75-4D	74	238	1.25	1.20	20	RF, EU
		3600	71	575 V	BA2M.75-5D	74	238	1.25	1.00	20	RF, EU
		1800	80	230/460 V	BA4M.75-4D	77	278	1.25	1.40	28	RF, EU
		1800	80	575 V	BA4M.75-5D	77	278	1.25	1.10	28	RF, EU
		1200	80	230/460 V	BA6M.75-4D	71	278	1.25	1.50	28	RF, EU
		1200	80	575 V	BA6M.75-5D	71	278	1.25	1.20	28	RF, EU
		900	90S/L	230/460 V	BA8M.75-4D	66	364	1.25	1.82	32	RF, EU
		900	90S/L	575 V	BA8M.75-5D	66	364	1.25	1.46	32	RF, EU
1	0.75	3600	80	230/460 V	BA2M001-4D	78	278	1.25	1.60	32	RF, EU
		3600	80	575 V	BA2M001-5D	78	278	1.25	1.30	32	RF, EU
		1800	80	230/460 V	BA4M001-4D	77	278	1.25	1.80	32	RF, EU
		1800	80	575 V	BA4M001-5D	77	278	1.25	1.40	32	RF, EU
		1200	90S	230/460 V	PA6M001-2D	80	325	1.25	1.90	32	RF, EU
		1200	90S	575 V	PA6M001-5D	80	325	1.25	1.50	32	RF, EU
1.5	1.1	3600	80	230/460 V	BA2M1.5-4D	79	278	1.25	2.30	32	RF, EU
		3600	80	575 V	BA2M1.5-5D	79	278	1.25	1.80	32	RF, EU
		1800	90S/L	230/460 V	BA4M1.5-4D	86.5	364	1.25	2.10	46	RF, EU
		1800	90S/L	575 V	BA4M1.5-5D	86.5	364	1.25	1.60	46	RF, EU
2	1.5	3600	90S/L	230/460 V	BA2M002-4D	85.5	364	1.25	2.60	46	RF, EU
		3600	90S/L	575 V	BA2M002-5D	85.5	364	1.25	2.00	46	RF, EU
		1800	90S/L	230/460 V	BA4M002-4D	86.5	364	1.25	2.90	50	RF, EU
		1800	90S/L	575 V	BA4M002-5D	86.5	364	1.25	2.30	50	RF, EU
		1200	100L	230/460 V	PA6M002-2D	88.5	388	1.25	3.00	92	RF, EU
		1200	100L	575 V	PA6M002-5D	88.5	388	1.25	2.40	92	RF, EU
3	2.2	3600	90S/L	230/460 V	BA2M003-4D	86.5	364	1.25	3.50	46	RF, EU
		3600	90S/L	575 V	BA2M003-5D	86.5	364	1.25	2.80	46	RF, EU
		1800	100L	230/460 V	BA4M003-4D	89.5	409	1.25	3.90	92	RF, EU
		1800	100L	575 V	BA4M003-5D	89.5	409	1.25	3.10	92	RF, EU
		1200	112M	230/460 V	PA6M003-2D	89.5	405	1.25	4.20	100	RF, EU
		1200	112M	575 V	PA6M003-5D	89.5	405	1.25	3.40	100	RF, EU



## W Series IEC 63-180L, 3 Phase - TEFC B5 (D-Flange With B3 Removable Feet) - Cast Aluminum

HP	Kw	RPM	Frame	Voltage	P/N	FL Eff.	L Dim. (mm)	S.F. 60 Hz	FL Amps	LBS	Notes
4	3	3600	100L	230/460 V	BA2M004-4D	88.5	409	1.25	4.90	60	RF, EU
		3600	100L	575 V	BA2M004-5D	88.5	409	1.25	3.90	60	RF, EU
		1800	100L	230/460 V	BA4M004-4D	89.5	409	1.25	5.50	60	RF, EU
		1800	100L	575 V	BA4M004-5D	89.5	409	1.25	4.40	60	RF, EU
		1200	132S	230/460 V	PA6M004-2D	89.5	459	1.25	6.10	110	RF, EU
		1200	132S	575 V	PA6M004-5D	89.5	459	1.25	4.80	110	RF, EU
5.5	4	3600	112M	230/460 V	BA2M5.5-4D	88.5	402	1.25	5.90	73	RF, EU
		3600	112M	575 V	BA2M5.5-5D	88.5	402	1.25	4.70	73	RF, EU
		1800	112M	230/460 V	BA4M5.5-4D	89.5	402	1.25	6.20	73	RF, EU
		1800	112M	575 V	BA4M5.5-5D	89.5	402	1.25	5.00	73	RF, EU
		1200	132M	230/460 V	PA6M5.5-2D	89.5	497	1.25	7.10	123	RF, EU
		1200	132M	575 V	PA6M5.5-5D	89.5	497	1.25	5.70	123	RF, EU
7.5	5.5	3600	132S/M	230/460 V	BA2M7.5-4D	89.5	484	1.25	8.40	110	RF, EU
		3600	132S/M	575 V	BA2M7.5-5D	89.5	484	1.25	6.70	110	RF, EU
		1800	132S/M	230/460 V	BA4M7.5-4D	91.7	484	1.25	9.80	110	RF, EU
		1800	132S/M	575 V	BA4M7.5-5D	91.7	484	1.25	7.80	110	RF, EU
		1200	132S/M	230/460 V	BA6M7.5-4D	91	484	1.25	10.60	123	RF, EU
		1200	132S/M	575 V	BA6M7.5-5D	91	484	1.25	8.50	123	RF, EU
10	7.5	3600	132S/M	230/460 V	BA2M010-4D	90.2	484	1.25	11.60	110	RF, EU
		3600	132S/M	575 V	BA2M010-5D	90.2	484	1.25	9.20	110	RF, EU
		1800	132S/M	230/460 V	BA4M010-4D	91.7	484	1.25	13.20	123	RF, EU
		1800	132S/M	575 V	BA4M010-5D	91.7	484	1.25	10.50	123	RF, EU
		1200	160M/L	230/460 V	BA6M010-4D	91	604	1.25	14.10	291	RF, EU, TM
		1200	160M/L	575 V	BA6M010-5D	91	604	1.25	17.70	291	RF, EU, TM
15	11	3600	160M/L	230/460 V	BA2M015-4D	91	604	1.25	17.00	221	RF, EU, TM
		3600	160M/L	575 V	BA2M015-5D	91	604	1.25	13.60	221	RF, EU, TM
		1800	160M/L	230/460 V	BA4M015-4D	92.4	604	1.25	17.80	221	RF, EU, TM
		1800	160M/L	575 V	BA4M015-5D	92.4	604	1.25	14.20	221	RF, EU, TM
		1200	160M/L	230/460 V	BA6M015-4D	91.7	604	1.25	19.30	234	RF, EU, TM
		1200	160M/L	575 V	BA6M015-5D	91.7	604	1.25	15.40	234	RF, EU, TM
20	15	3600	160M/L	230/460 V	BA2M020-4D	91	604	1.25	22.20	221	RF, EU, TM
		3600	160M/L	575 V	BA2M020-5D	91	604	1.25	17.70	221	RF, EU, TM
		1800	160M/L	230/460 V	BA4M020-4D	93	604	1.25	23.30	234	RF, EU, TM
		1800	160M/L	575 V	BA4M020-5D	93	604	1.25	18.60	234	RF, EU, TM
		1200	180M/L	230/460 V	BA6M020-4D	91.7	663	1.25	25.70	380	RF, EU, TM
		1200	180M/L	575 V	BA6M020-5D	91.7	663	1.25	20.60	380	RF, EU, TM
25	18.5	3600	160M/L	230/460 V	BA2M025-4D	91.7	604	1.25	27.20	234	RF, EU, TM
		3600	160M/L	575 V	BA2M025-5D	91.7	604	1.25	21.76	234	RF, EU, TM
		1800	180M/L	230/460 V	BA4M025-4D	93.6	663	1.25	27.90	329	RF, EU, TM
		1800	180M/L	575 V	BA4M025-5D	93.6	663	1.25	22.32	329	RF, EU, TM
30	22	3600	180M/L	230/460 V	BA2M030-4D	91.7	663	1.25	32.40	329	RF, EU, TM
		3600	180M/L	575 V	BA2M030-5D	91.7	663	1.25	25.92	329	RF, EU, TM
		1800	180M/L	230/460 V	BA4M030-4D	93.6	663	1.25	33.90	380	RF, EU, TM
		1800	180M/L	575 V	BA4M030-5D	93.6	663	1.25	27.12	380	RF, EU, TM

Discount Category **17**



## NEMA TEFC Dimensions Frame Sizes 56 - 586

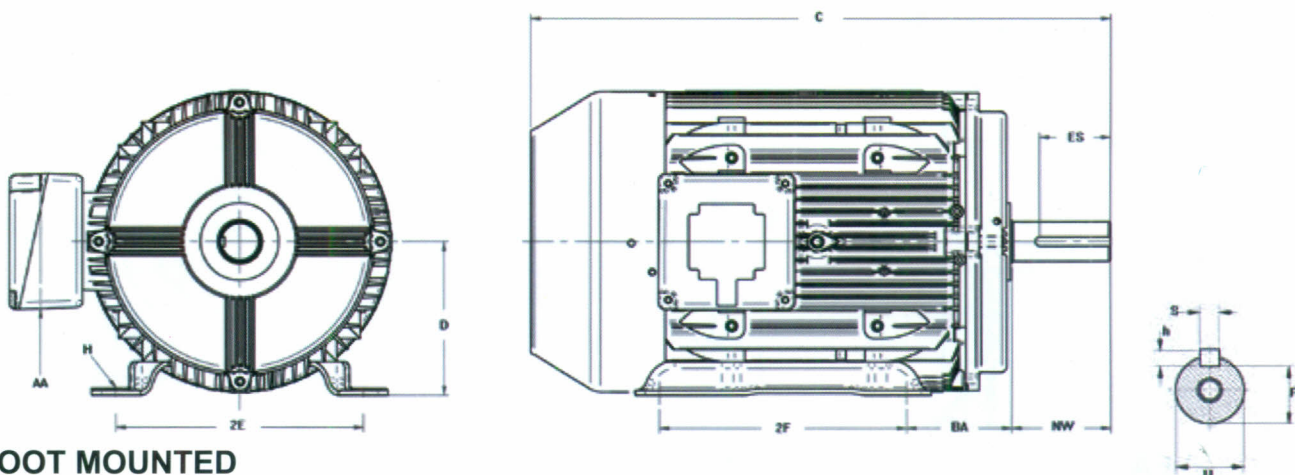

**FOOT MOUNTED**

Frame Size	FOOT INSTALLATION DIM.				SHAFT INSTALLATION DIM.						GENERAL DIM.	
	2E	2F	H	BA	N-W	U	S	AH	R	ES	D	AA
56	4.87	3.0	0.34	2.75	1.875	0.625	0.187	2.062	0.517	1.37	3.50	0.50
143T	5.5	4.0	0.34	2.25	2.25	0.875	0.187	2.125	0.771	1.37	3.50	0.75
145T		5.0	0.34	2.25	2.25	0.875	0.187	2.125	0.771	1.37	3.50	0.75
182T	7.5	4.5	0.50	2.75	2.75	1.125	0.25	2.625	0.986	1.88	4.50	0.75
184T		5.5	0.50	2.75	2.75	1.125	0.25	2.625	0.986	1.88	4.50	0.75
213T	8.5	5.5	0.50	3.50	3.375	1.375	0.312	3.125	1.201	2.38	5.25	1.00
215T		7.0	0.50	3.50	3.375	1.375	0.312	3.125	1.201	2.38	5.25	1.00
254T	10	8.25	0.59	4.25	4.00	1.625	0.375	3.75	1.416	2.87	6.25	1.25
256T		10	0.59	4.25	4.00	1.625	0.375	3.75	1.416	2.87	6.25	1.25
284T	11	9.5	0.59	4.75	4.625	1.875	0.50	4.375	1.591	3.25	7.00	1.50
284TS		9.5	0.59	4.75	3.25	1.625	0.375	3.00	1.416	1.87	7.00	1.50
286T	11	11	0.59	4.75	4.625	1.875	0.50	4.375	1.591	3.25	7.00	1.50
286TS		11	0.59	4.75	3.25	1.625	0.375	3.00	1.416	1.87	7.00	1.50
324T	12.5	10.50	0.63	5.25	5.25	2.13	0.50	5.00	1.845	4.75	8.00	2.00
324TS		10.50	0.63	5.25	3.75	1.88	0.50	3.50	1.591	3.25	8.00	2.00
326T	12.5	12	0.63	5.25	5.25	2.13	0.50	5.00	1.845	4.75	8.00	2.00
326TS		12	0.63	5.25	3.75	1.88	0.50	3.50	1.591	3.25	8.00	2.00
364T	14	11.25	0.63	5.88	5.88	2.38	0.63	5.38	2.021	5.00	9.00	3.00
364TS		11.25	0.63	5.88	3.75	1.88	0.50	3.50	1.591	3.25	9.00	3.00
365T	14	12.25	0.63	5.88	5.88	2.38	0.63	5.38	2.021	5.00	9.00	3.00
365TS		12.25	0.63	5.88	3.75	1.88	0.50	3.50	1.591	3.25	9.00	3.00
404T	16	12.25	0.75	6.63	7.25	2.88	0.75	7.25	2.450	6.50	10.00	3.00
404TS		12.25	0.75	6.63	4.25	2.13	0.50	4.00	1.845	3.25	10.00	3.00
405T	16	13.75	0.75	6.63	7.25	2.88	0.75	7.25	2.450	6.50	10.00	3.00
405TS		13.75	0.75	6.63	4.25	2.13	0.50	4.00	1.845	3.25	10.00	3.00
444T	18	14.50	0.75	7.50	8.50	3.38	0.88	8.25	2.880	7.00	11.00	3.00
444TS		14.50	0.75	7.50	4.75	2.38	0.63	4.50	2.021	4.13	11.00	3.00
445T	18	16.50	0.75	7.50	8.50	3.38	0.88	8.25	2.880	7.00	11.00	3.00
445TS		16.50	0.75	7.50	4.75	2.38	0.63	4.50	2.021	4.13	11.00	3.00
447T	18	20	0.75	7.50	8.50	3.38	0.88	8.25	2.880	7.00	11.00	3.00
447TS		20	0.75	7.50	4.75	2.38	0.63	4.50	2.021	4.13	11.00	3.00
504Z	20	16	1.00	8.50	9.25	3.63	0.88	9.00	3.134	8.50	12.50	3.00
504SZ		16	1.00	8.50	5.50	2.75	0.63	5.25	2.402	4.88	12.50	3.00
505Z	20	18	1.00	8.50	9.25	3.63	0.88	9.00	3.134	8.50	12.50	3.00
505SZ		18	1.00	8.50	5.50	2.75	0.63	5.25	2.402	4.88	12.50	3.00
585Z	24	20	1.00	10.00	10.00	3.88	1.00	10.00	3.309	9.75	14.50	3.00
585SZ		20	1.00	10.00	7.75	3.00	0.75	7.75	2.569	7.75	14.50	3.00
586Z	24	22	1.00	10.00	10.00	3.88	1.00	10.00	3.309	9.75	14.50	3.00
586SZ		22	1.00	10.00	7.75	3.00	0.75	7.75	2.569	7.75	14.50	3.00



# NEMA TEFC Dimensions

## Frame Sizes 56 - 586

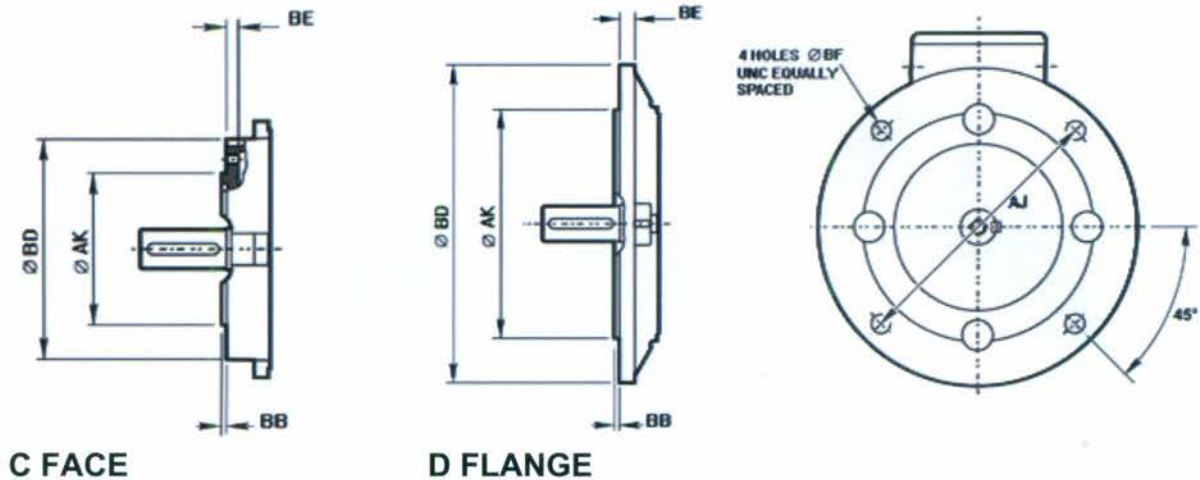

Frame Size	D FLANGE DIMENSIONS					C FACE DIMENSIONS				
	AJ	AK	BB	BD	BF	AJ	AK	BB	BD	BF
56	-	-	-	-	-	5.87	4.5	0.12	6.5	0.37
143T	10	9	0.25	11	0.53	5.87	4.5	0.12	6.5	0.37
145T	10	9	0.25	11	0.53	7.25	8.5	0.16	9	0.50
182T	10	9	0.25	11	0.53	7.25	8.5	0.25	6.5	0.50
184T	10	9	0.25	11	0.53	7.25	8.5	0.16	9	0.50
182TCH	-	-	-	-	-	5.88	4.5	0.25	6.5	0.38
184TCH	-	-	-	-	-	5.88	4.5	0.16	6.5	0.38
213T	10	9	0.25	11	0.53	7.25	8.5	0.25	9	0.50
215T	10	9	0.25	11	0.53	7.25	8.5	0.25	9	0.50
254T	12.50	11	0.25	14	0.81	7.25	8.5	0.25	9.84	0.50
256T	12.50	11	0.25	14	0.81	7.25	8.5	0.25	9.84	0.50
284T	12.50	11	0.25	14	0.81	9	10.5	0.25	11.25	0.50
286T	12.50	11	0.25	14	0.81	9	10.5	0.25	11.25	0.50
284TS	12.50	11	0.25	14	0.81	9	10.5	0.25	11.25	0.50
286TS	12.50	11	0.25	14	0.81	9	10.5	0.25	11.25	0.50
324T	16	14	0.25	17.75	0.81	11	12.50	0.25	13	0.63
326T	16	14	0.25	17.75	0.81	11	12.50	0.25	13	0.63
324TS	16	14	0.25	17.75	0.81	11	12.50	0.25	13	0.63
326TS	16	14	0.25	17.75	0.81	11	12.50	0.25	13	0.63
364T	16	14	0.25	17.75	0.81	11	12.50	0.25	13.75	0.63
365T	16	14	0.25	17.75	0.81	11	12.50	0.25	13.75	0.63
364TS	16	14	0.25	17.75	0.81	11	12.50	0.25	13.75	0.63
365TS	16	14	0.25	17.75	0.81	11	12.50	0.25	13.75	0.63
404T	20	18	0.25	21.63	0.81	11	12.50	0.25	14.50	0.63
405T	20	18	0.25	21.63	0.81	11	12.50	0.25	14.50	0.63
404TS	20	18	0.25	21.63	0.81	11	12.50	0.25	14.50	0.63
405TS	20	18	0.25	21.63	0.81	11	12.50	0.25	14.50	0.63
444T	20	18	0.25	21.63	0.81	14	16	0.25	17.50	0.63
445T	20	18	0.25	21.63	0.81	14	16	0.25	17.50	0.63
444TS	20	18	0.25	21.63	0.81	14	16	0.25	17.50	0.63
445TS	20	18	0.25	21.63	0.81	14	16	0.25	17.50	0.63
447T	20	18	0.25	21.63	0.81	14	16	0.25	17.50	0.63
449T	20	18	0.25	21.63	0.81	14	16	0.25	17.50	0.63
447TS	20	18	0.25	21.63	0.81	14	16	0.25	17.50	0.63
449TS	20	18	0.25	21.63	0.81	14	16	0.25	17.50	0.63
504SZ	22	18	0.25	25	0.94	14.50	16.50	0.25	17.50	0.63
504Z	22	18	0.25	25	0.94	14.50	16.50	0.25	17.50	0.63
505SZ	22	18	0.25	25	0.94	14.50	16.50	0.25	17.50	0.63
505Z	22	18	0.25	25	0.94	14.50	16.50	0.25	17.50	0.63
585SZ	29.13	26.77	0.25	31.50	0.94	-	-	-	-	-
585Z	29.13	26.77	0.25	31.50	0.94	-	-	-	-	-
586SZ	29.13	26.77	0.25	31.50	0.94	-	-	-	-	-
586Z	29.13	26.77	0.25	31.50	0.94	-	-	-	-	-

## IP (Ingress Protection) Definition

### Definition IP (Ingress Protection) IEC Metric Motors

IP 5 5

Protection Against Solid Objects			Protection Against Liquids		
#	Brief Description*	Definitions	#	Brief Description*	Definitions
0	Non-protected machines	No special protection	0	Non-protected machines	No special protection
1	Machine protected against solid objects greater than 50 mm**	Accidental or inadvertent contact with or approach to live and moving parts inside the enclosure by a large surface of the human body, such as a hand (but no protection against deliberate access). Ingress of solid objects exceeding 50 mm in diameter	1	Machine protected against dripping water	Dripping water (vertically falling drops) shall have no harmful effect.
2	Machine protected against solid objects greater than 12 mm**	Contact by fingers or similar objects not exceeding 80 mm in length with or approach to live or moving parts inside the enclosure. Ingress of solid objects exceeding 12 mm in diameter.	2	Machine protected against dripping water when tilted up to 15°	Vertically dripping water shall have no harmful effect when the machine is tilted in any angle up to 15° from its normal position
3	Machine protected against solid objects greater than 2.5 mm**	Contact with or approach to live or moving parts inside the enclosure by tools or wires exceeding 2.5 mm in diameter. Ingress of solid objects exceeding 1 mm in diameter.	3	Machine protected against spraying water	Vertically dripping water shall have no harmful effect when the machine is tilted in any angle up to 15° from its normal position
4	Machine protected against solid objects greater than 1 mm**	Contact with or approach to live or moving parts inside the enclosure by wires or strips of thickness greater than 1 mm in diameter.	4	Machine protected against splashing water	Water falling as a spray at any angle up to 60° from the vertical shall have no harmful effect
5	Dust-protected machine†	Contact with or approach to live or moving parts inside the enclosure. Ingress of dust is not totally prevented but dust does not enter in sufficient quantity to interfere with satisfactory operation of the machine.	5	Machine protected against water jets	Water projected by a nozzle against the machine from any direction shall have no harmful effect.
6	Dust-tight machine†	Contact with or approach to live or moving parts inside the enclosure. No ingress of dust	6	Machine protected against heavy seas	Water from heavy seas or water projected in powerful jets shall not enter the machine in harmful quantities.

\* The brief description given in column 2 on this table should not be used to specify the form of protection.

\*\* Machines assigned a first characteristic number 1,2,3 or 4 will exclude both regularly or irregularly shaped solid objects proved that three normally perpendicular dimensions of the object exceed the appropriate figure in column "Definition".

† The degree of protection against dust defined by this standard is a general one. When the nature (dimensions of particles, their nature, for instance fibrous particles) is specified, test conditions should be determined by an agreement between manufacturer and user.



# Mounting Codes

## IEC Mounting Codes

Horizontal shaft:



IM B3  
IM 1001  
foot mounted

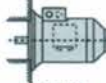

IM B5  
IM 3001  
flange at DE  
no feet



IM B6  
IM 1051  
foot wall mounted with  
feet on left-hand side  
when viewed from DE



IM B7  
IM 1061  
foot wall mounted with  
feet on right-hand side  
when viewed from DE



IM B8  
IM 1071  
ceiling mounted  
with feet  
above motor

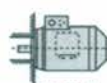

IM B14  
IM 3601  
face at DE  
no feet

Vertical shaft:



IM V1  
IM 3011  
flange at DE  
shaft down  
no feet



IM V3  
IM 3031  
flange at DE  
shaft up  
no feet



IM V5  
IM 1011  
vertical foot  
wall mounted  
shaft down



IM V6  
IM 1031  
vertical foot  
wall mounted  
shaft up



IM V18  
IM 3611  
face at DE  
shaft down  
no feet



IM V19  
IM 3631  
face at DE  
shaft up  
no feet

## NEMA Mounting Codes

### FLOOR MOUNTINGS



ASSEMBLY F-1

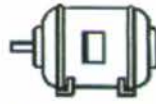

ASSEMBLY F-2



ASSEMBLY F-3

### WALL MOUNTINGS



ASSEMBLY W-1



ASSEMBLY W-2



ASSEMBLY W-3



ASSEMBLY W-4



ASSEMBLY W-5



ASSEMBLY W-6



ASSEMBLY W-7



ASSEMBLY W-8



ASSEMBLY W-9



ASSEMBLY W-10



ASSEMBLY W-11



ASSEMBLY W-12

### CEILING MOUNTINGS



ASSEMBLY C-1

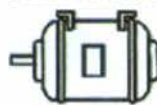

ASSEMBLY C-2



ASSEMBLY C-3